

# BRISTAN

## Vandal Resistant Shower Head Fitting Instructions

Please keep these instructions for future reference

Before starting any installation project please consider:



Prior to drilling into walls, check there are no hidden electrical wires, cables or water supply pipes with the aid of an electronic detector. If you use power tools do not forget:

- Wear eye protection
- Unplug equipment after use

Form No. 800025/C

### GUARANTEE - SERVICE POLICY (Available in UK and ROI only)

This product is guaranteed against faulty materials and workmanship for 12 months from date of purchase. For the guarantee to be valid, the unit must be installed by a competent person, in accordance with the instruction booklet. Any part found to be defective during the guarantee period, will (at our option) be repaired or replaced, free of charge, provided the unit has been installed, and properly used in accordance with the instruction booklet. This guarantee does not affect your statutory rights.

Please have the following handy: Model type, Date of purchase, Product number (if available).

The Customer Service Department will attempt to diagnose the cause of the fault and advise the necessary action to resolve the problem over the phone. If the fault can not be resolved and a service call is required, a Site Visit Request form will be sent to you to complete and return.

Where applicable a fixed fee payment for parts and/or labour will be levied. The cost incurred and payment methods will be advised over the phone and on the Site Visit Request form. A completed form, along with payment (if applicable) must be received before the Service callout can be arranged. If the fault is not product related or is a component not of our manufacture, a fixed fee will be made to cover Site visit costs. Additional costs for parts used to rectify related problem may be imposed.

During the visit, yourself or a responsible person should be present at all times. Charges will be made if the Service Engineer or Agent can not gain site access at the prearranged time.

Ensure water and/or electricity supplies have adequate isolation to the unit. If the unit is concealed, serviceable access should be available. If servicing difficulties arise from not making the provisions detailed, additional time related costs or a recall charge will be imposed.

Bristan Group Ltd, Birch Coppice Business Park, Dordon, Tamworth, Staffordshire, B78 1SG, T: 0844 7016274, E: [customercare@bristan.com](mailto:customercare@bristan.com)

**Customer Care ☎ 0844 7016273**

This Shower head is intended to be used in conjunction with other products such as a thermostatic mixing valve

### INSTALLATION

The Shower head should be arranged in your system with a supply of mixed water.

#### For Concealed Pipework

Connect the Shower head's 1/2" connector to pipe work using the 1/2" BSP connections, secure the backplate to wall with screws and plugs provided. Attach showerhead to the backplate and secure with grub screw using a hexagonal key.

#### For Exposed Pipework

Secure the Sealing plug to the front of the Backplate ensuring the O'ring is fitted. Loosely connect the Shower head to pipe work to mark out position the back plate on the wall. Remove the Shower head, Drill the wall and affix the Backplate to the wall using screws and plugs provided. Replace the fixed head pipework, securing with the grub screw.

**NOTE:- Before finishing the installation turn on water supplies to check for correct system function and for leaking from joints/connections.**

#### Concealed rear inlet

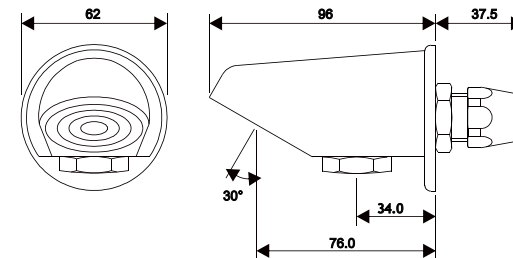
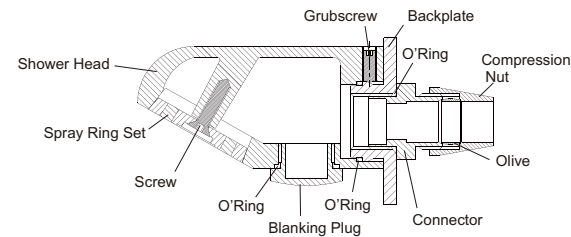

#### Exposed bottom inlet

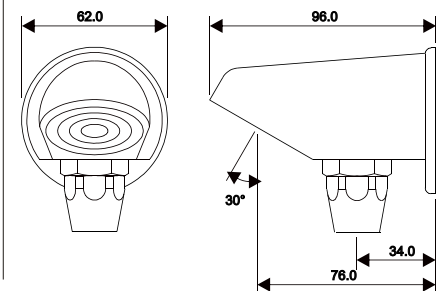
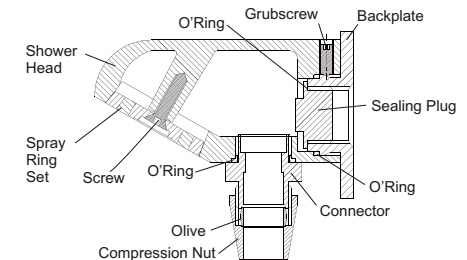

Dimensions in mm  
Drawings are for reference only

### ECONOMY FLOW CONTROL

When a VR1000 is installed with a time flow control we recommend that a 7 litre flow limiter is fitted to limit the shower head flow rate at about 7 litres maximum.

Please note flow limiters are not supplied with this product and can be purchased separately.

[www.qssupplies.co.uk](http://www.qssupplies.co.uk)