



**Bath waste with chrome parking
plug
Product Code: BW105**



Installation & User Guide

INSTALLATION

1. Identify all your core components and check the waste is complete.
2. Fit the waste body (11) to the underside of the bath, using the waste sealing washer (10), using silicone sealant where necessary. Fit the waste grid (8) to the waste hole in the bath, using the optional waste sealing washer (9), alternatively silicone sealant may be used instead. Secure the waste using waste retaining screw (7).
3. Fit the overflow elbow (1) to the underside of the over hole of your bath. Attach the chrome overflow cover (3) to the overflow elbow using the overflow screw (4) ensuring the and overflow sealing washer (2) are fitted as shown overleaf, using silicone sealant where necessary.
4. Connect the overflow tube (12) to both the over flow elbow (1) and waste body (11)

NB - do not over tighten waste retaining screw (7)

- 4 .Check all joints and connections for leaks.
5. See over the page for aftercare instructions.

COMPONENTS

1. BW111 OVERFLOW ELBOW
2. BW112 OVERFLOW WASHER
3. BW113 OVERFLOW GRID
4. BW114 OVERFLOW SCREW
5. BW115 PLUG AND CHAIN C/W O'RING
6. BW116 WASTE CENTRE SCREW
7. BW117 WASTE FLANGE
8. BW118 WASTE FLANGE WASHER
9. BW119 WASTE BODY WASHER
10. BW120 WASTE BODY WASHER
11. BW121 WASTE BODY
12. BW122 OVERFLOW TUBE

To order spare part please call our technical helpline on 01892611240 selecting option 2

EXPLODED COMPONENT VIEW

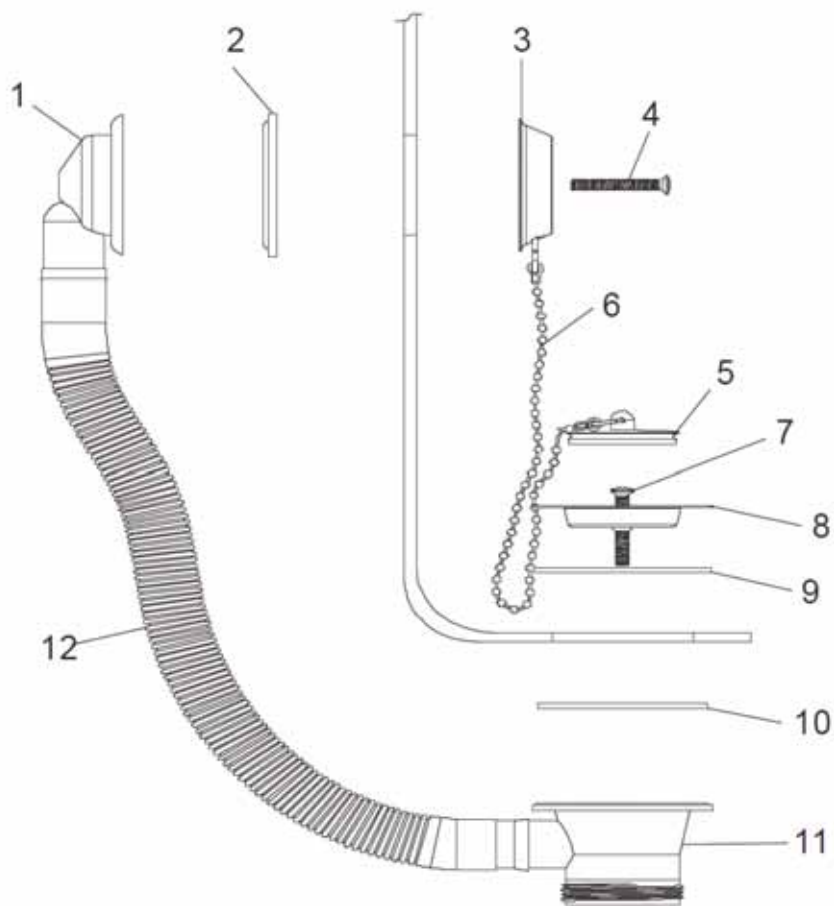

AFTERCARE INSTRUCTIONS

This waste fitting has a high quality finish and therefore should be treated with care to preserve the chrome plated surfaces. All surface finishes will wear if not cleaned correctly, the only safe way to clean your waste is to wipe with a soft damp cloth. Stains can be removed using a neutral washing up liquid. All bath cleaning powders and liquids will damage the surface of your fitting even the non-scratch cleaners.

GUARANTEE

All products are manufactured to the highest standards and a 10-year guarantee covers any defect in manufacture. If you should experience any problems with your waste, contact our technical help line quoting the product or component code. All working parts such as seals which are subject to normal wear and tear, are covered for 12 months from proof of purchase date.

Pura Bathrooms Limited
15 Millbrook Industrial Estate
Crowborough
East Sussex
TN6 3DU

Office Tel: 01892611240
Office Fax: 01892613000

Email: sales@purabathrooms.com
technical@purabathrooms.com

Website: www.purabathrooms.com