



**Bath waste with chrome clicker
waste
Product Code: CB105**



Installation & User Guide

Please retain this booklet for future aftercare reference



INSTALLATION

1. Identify all your core components and check the waste is complete.
2. Fit the brass waste body (13) through the bath and screw into the plastic waste body (9) ensure seating washers 7, 8 & 10 are placed in the order shown in the component view adjacent, secure this with the back nut (6) using silicone sealant where necessary. Optional washer (12) may be fitted between the brass waste body fitting (13) and the bath, alternatively silicone sealant may be used in place of this.
3. Fit the overflow elbow (4) to the underside of the over hole of your bath screwing the chrome overflow cover into the overflow elbow ensuring the black pvc washer (3) is placed between the bath and the overflow elbow, using silicone sealant where necessary.
4. Connect the overflow tube to both the over flow elbow and plastic waste body

NB - do not over tighten the back nut (6)

4. Check all joints and connections for leaks.
5. See over the page for aftercare instructions.

COMPONENTS

1. WS125 CHROME OVERFLOW COVER FOR CB105
3. WS126 BLACK PVC NO.3
4. WS127 OVERFLOW ELBOW
5. WS130 OVERFLOW TUBE
6. WS128 BACKNUT
7. WS121 WHITE PE WASHER
8. WS122 BLACK PVC WASHER
9. WS129 PLASTIC WASTE BODY
10. WS122 BLACK PVC WASHER
12. WS120 WHITE FOAM WASHER
13. WS165 BRASS WASTE BODY
14. WS124 CHROME PLUG
15. WS190 SEALING WASHER FOR CB105
16. WS123 CLICKER MECHANISM CB105

To order spare part please call our technical helpline on 01892611240 selecting option 2

EXPLODED COMPONENT VIEW

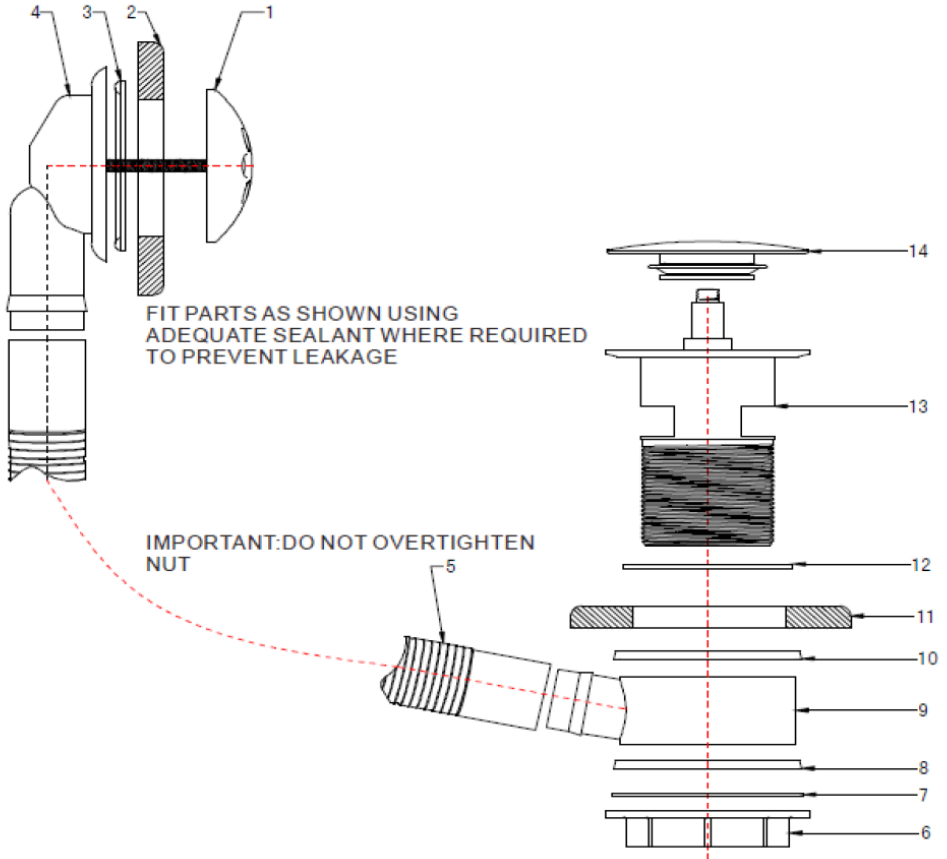

AFTERCARE INSTRUCTIONS

This waste fitting has a high quality finish and therefore should be treated with care to preserve the chrome plated surfaces. All surface finishes will wear if not cleaned correctly, the only safe way to clean your waste is to wipe with a soft damp cloth. Stains can be removed using a neutral washing up liquid. All bath cleaning powders and liquids will damage the surface of your fitting even the non-scratch cleaners.

GUARANTEE

All products are manufactured to the highest standards and a 10-year guarantee covers any defect in manufacture. If you should experience any problems with your waste, contact our technical help line quoting the product or component code. All working parts such as seals which are subject to normal wear and tear, are covered for 12 months from proof of purchase date.

Pura Bathrooms Limited
15 Millbrook Industrial Estate
Crowborough
East Sussex
TN6 3DU

Office Tel: 01892611240
Office Fax: 01892613000

Email: sales@purabathrooms.com
technical@purabathrooms.com

Website: www.purabathrooms.com