

Fitting Instructions

Janus / Orion Composite Sink

Notes prior to installation:

The position of your sink will be determined by the relationship of the sink rim to cabinet gables, supports and tap location.

You will need:

Fitting clips (included)
Electric saw with jigsaw fitment
Translucent Silicone / Sealant

Screwdriver
35mm Hole Saw

- 1 Place the sink face down on the underside of the worksurface and draw around the edge of the sink rim. Measure 8mm in from the sink edge and draw a second line all the way around following the original line.

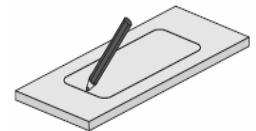

- 2 Cut out the hole for your sink following the second line, 8mm in from the original outline.

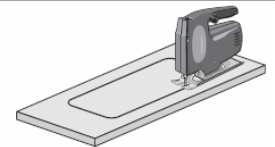

- 3 Fix the clips (supplied) to the bosses on the underside of the sink.

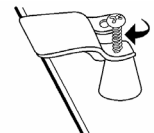

- 4 The sink can be mounted with the drainer on the left or the right hand side so take care to select the correct side to remove the tap hole. On the underside of the sink is a location point to drill a pilot hole. Turn the sink back over the right way and using the 35mm hole saw cut to obtain the tap hole.

- 5 Clean the adjoining area of the sink rim and worksurface with a solvent to remove any dust or grease. Apply a continuous bead of translucent silicone to the worksurface or the sink rim or use the sealing strip provided.



- 6 Position the sink in the cut out hole and position the clip leg into position. lightly hand tighten the screws starting in the middle of the back edge of the sink. Secure the screw directly opposite that to ensure correct fitting. If required re-align the sink within the hole before hand tightening the clips.

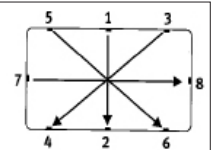

- 7 Use a damp cloth to remove any excess silicone that has been squeezed out beyond the cut out edge.



Cleaning & Care Instructions

Day to day care of your sink:

Your new sink is manufactured in an extremely tough and resilient material. To maintain its good looks, we suggest you follow these simple guidelines.

It is good practice to clean your sink immediately after use. Most deposits can be removed with washing up liquid and hot water, followed by a clean water rinse then drying with a soft cloth to prevent limescale build-up.

For more stubborn deposits use a non-abrasive cream cleaner without added bleach. This should be applied with a soft damp cloth, again followed by a clean water rinse and dry.

Never use a metal scouring pad or wire wool as these may leave deposits which rust and give the appearance of staining.

The quality of your water can affect the good looks of your sink by giving the appearance of staining. This 'staining' is generally a build up of limescale or similar mineral deposit, particularly prevalent in hard water areas. Limescale readily absorbs staining agents such as tea, coffee, red wine etc, spoiling the appearance of your sink. For this reason always rinse and dry your sink after each use to avoid mineral deposits being left behind on the surface when the water evaporates.

Take care to avoid

Bleach or other cleaning agents containing bleach should not be left in contact with your sink as discolouration or pitting of the surface could result.