

# Wall Mounted Infra-Red Spout, Round SF1249CP

## Installation Instructions & Maintenance Guide

---

Your product has a high quality finish and should be treated with care to preserve the visible surfaces.

Never use abrasives or abrasive cleaning agents to clean this product. Clean regularly with contamination free warm soapy water and a damp soft cloth. Do not use products containing chlorine bleach or hydrochloric acid as these can damage the product. Always rinse the product thoroughly after cleaning to remove cleaning products that can damage the product finish.

Your product comes with a 2 year guarantee, This includes 2 years parts and labour followed by a further 3 years parts only, subject to the following:

Proof of purchase will be required

The guarantee does not cover faults or damage caused by incorrect installation and/or maintenance, ordinary wear and tear, water composition etc. including:

Supply pipes reversed, Incorrect pressure or temperature, \*Incorrect use, Foreign bodies and/or scale due to the water composition, Incorrect cleaning.

We have a policy of continuous improvement and reserve the right to change specifications without notice

Twyford Bathrooms Registered Office  
Geberit House  
Edgehill Drive  
Warwick  
Warwickshire  
CV34 6NH

Part of the Geberit Group

UK Technical Helpline  
Telephone: 01926 516800  
Email: [technical@geberit.com](mailto:technical@geberit.com)

Website: [www.twyfordbathrooms.com](http://www.twyfordbathrooms.com)

P8

### Technical Specifications:

#### Supply:

Suitable For High Pressure Systems

#### Working Pressure:

0.5 bar - 5.0bar

#### Operating Temperature:

Hot: Max 45°C

Cold: Min 5°C

#### Inlet Connections:

1/2" BSP

#### Cartridge/Valve Type:

Electro Valve



IMPORTANT: Please read all of the instructions before installation.

**Twyford**  
Geberit Group

**LINE DRAWING**

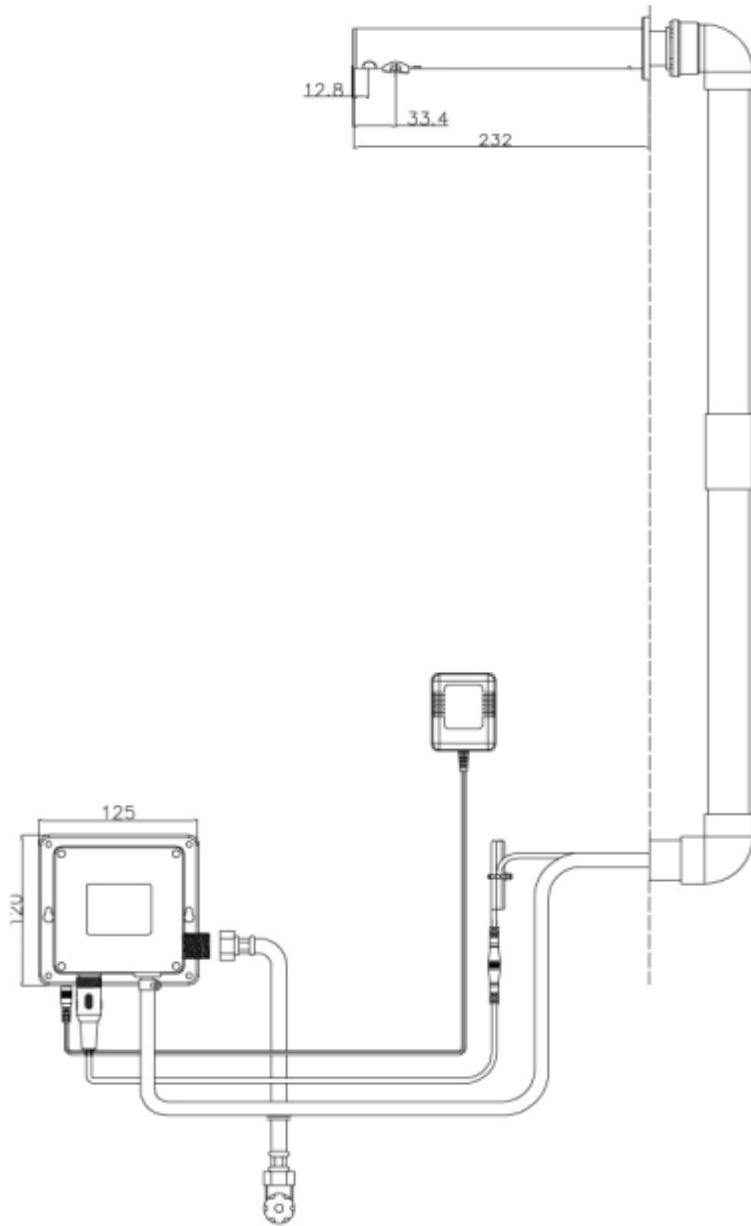

P2

**Signal Line Connection**

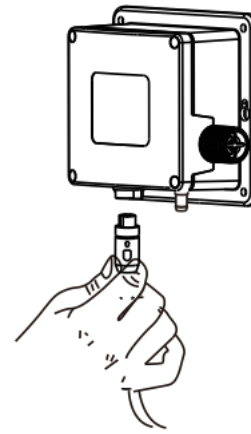

Connect the sensor cable to the control box, then screw knurled ring to secure.

Power connect  
AC: Connect the  
transformer

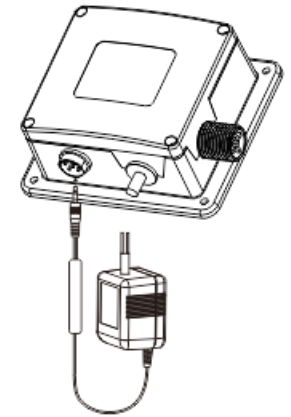

DC: Install 4AA alkaline battery into the battery box (Battery included)

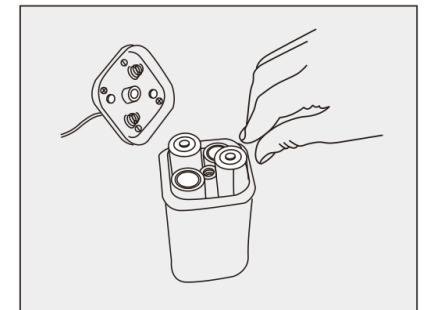
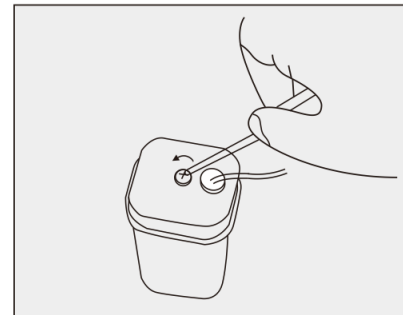

P7

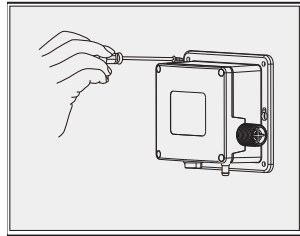

- 1 Put the control box on wall, drill four holes, then insert the plastic wall plugs.
- 2 Fix the control box on wall using screws supplied.

**Note:** Isolate the water supply and turn off the power before installing.  
 Be sure to install control box the correct way around, don't fit upside down.  
 Choose a suitable place to install control box for easy maintenance.  
 Must be less than 50cm distance from the basin.

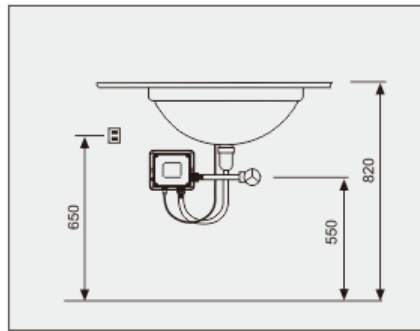

**Water Connection**

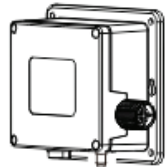

1. Water outlet hose connect, Connect the tap body to the control box using the flexible hose, ensure the pipe clamp is tightly secured.



2. Connect the control box water inlet to the water supply using the water inlet hose.

**Note:** Be sure to check for water leakage after connecting water

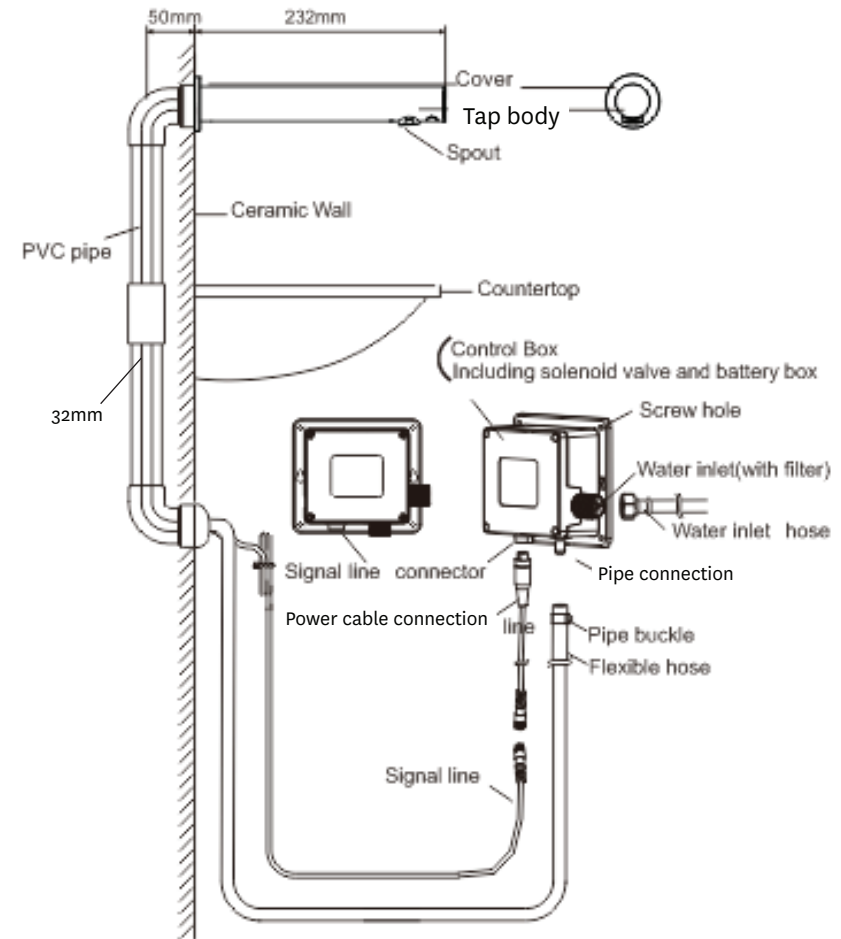

Wall Mounted Infra-Red Spout, Square - SFI 250CP						
Dynamic Pressure	0.5 bar	1 bar	1.5 bar	2.0 bar	3.0 bar	5.0 bar
Flow Rate (Litre's per minute)	4.3	3.8	3.8	3.8	3.8	3.8

**TECHNICAL SPECIFICATION**

Item	SF1249CP
Power	DC:6V (4AA alkaline battery)
	AC:220V50/60HZ
Power Consumption	DC:<0.2mW: AC:<2W
Sensor Time	Opening Time <1S, Closing Time <1.5S
Water Pressure	0.05MPa-0.6MPa
Sensing Distance	Sensor Range: Factory Setting: 15Cm, Tolerance: 0%
	Range Setting: 5-25cm
Temperature	1°C -55°C
Water Temperature	1°C -45°C
Dia. Of Inlet Pipe	G1/2"

**GENERAL CHARACTERISTICS**

This product should be installed by a qualified plumber in compliance with all relevant Water Authority Regulations. If you are unsure as to what the regulations require, you can contact your Local Water Authority or the institute of Plumbers for further details.

This product is safe provided it is installed, used and maintained in accordance with these instructions and recommendations.

**PLEASE RETAIN THIS DOCUMENT FOR FUTURE REFERENCE**

**INSTALLATION**

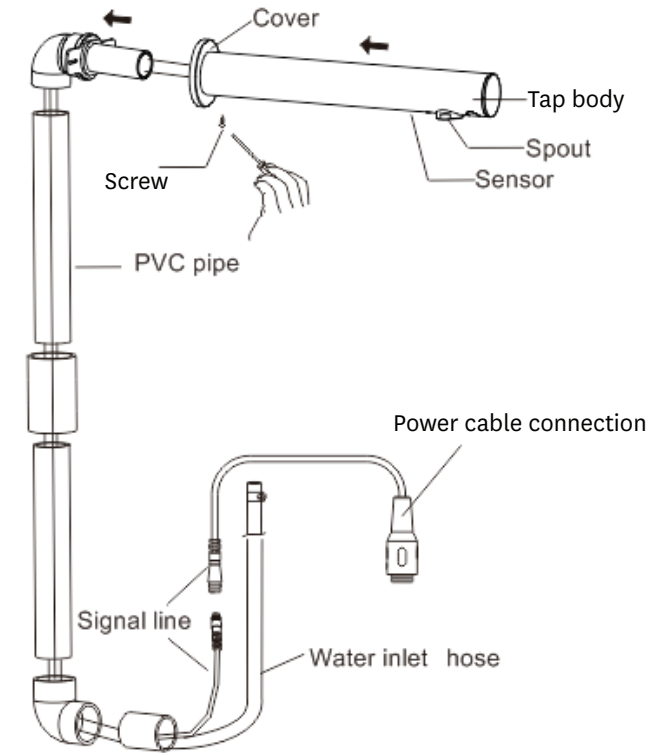

**STEP:**

- 1 Insert PVC pipe into the wall and install the tap body and sensor cable as shown above.
- 2 Screw fixed joint and screw tap tightly, then close the wall plate.