

## CUSTOMER DATA SHEET

SALES CODE: SAR101

DESCRIPTION: 700 W/H 2 Drawer Unit & Basin

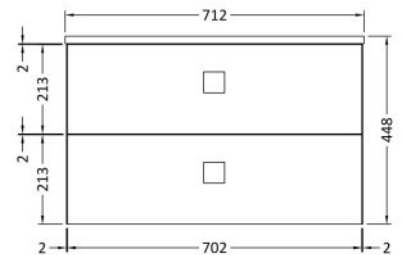
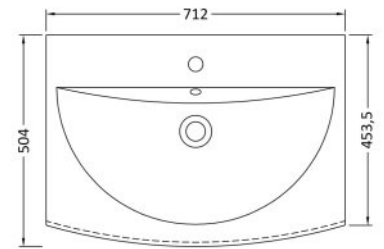
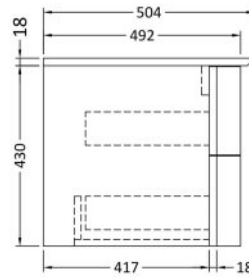

### PACKAGING DETAILS

Barcode

5056211875031

## CUSTOMER DATA SHEET - FURNITURE

SALES CODE: SAR194

DESCRIPTION: 700 W/H 2 Drawer Unit

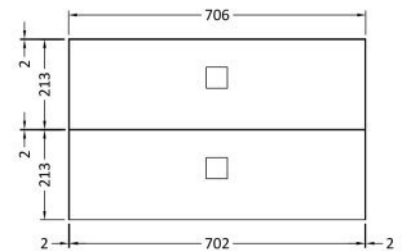
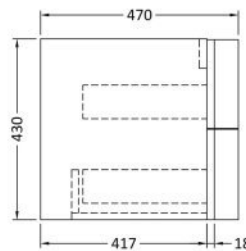
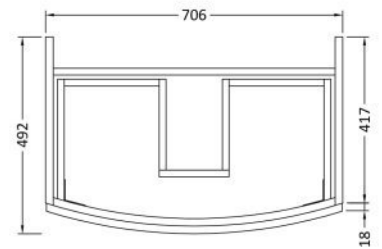

### PRODUCT DIMENSIONS

Height (mm)	Width (mm)	Depth (mm)	Nett Wgt Kg
430	710	480	22

### PACKAGING DIMENSIONS

Height (mm)	Width (mm)	Depth (mm)	Gross Wgt Kg
500	700	470	22

### PACKAGING DATA

Box Colour	Brown Cardboard Box		
Box Qty	1	Label Colour	White Label
Label Size	100 x 50	Label Qty	2

### OUTER BOX DIMENSIONS (If Applicable)

Height (mm)	Width (mm)	Depth (mm)	Gross Wgt Kg
Barcode	5056211873877		

### PRODUCT DETAILS

Country of Origin	Ukraine
Fitting Instruction	No
Constr' Method	Cam & Wood Dowel
Cabinet Finish	Mdf Vinyl Textured Woodgrain
Cab Thickness (mm)	18
Drawer Included	Yes
No of Shelves	0
Hinge Inc'	Not Applicable
Fixings Inc'	Yes
Handle Inc'	Yes
Handle Type	Square

Certification	FSC	Yes	CE	N/A
Colour	Moon White			
Constr' Type	Rigid			
Fascia Finish	Mdf Vinyl Textured Woodgrain			
Fas Thickness (mm)	18			
Drawer Type	80mm High Metal Softclose			
Hinge Type	Not Applicable			
Adjustable Legs	No			
Handle Style	Modern			
Waste Shroud	Yes			

## CUSTOMER DATA SHEET - CERAMICS

SALES CODE: FMB0073

DESCRIPTION: 712 X 506 Vanity Basin

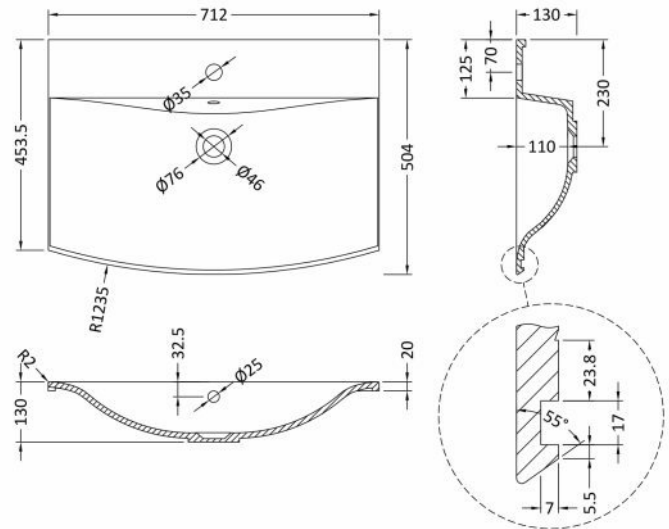

### PRODUCT DIMENSIONS

Height (mm)	Width (mm)	Depth (mm)	Nett Wgt Kg
130	712	505	10

### PACKAGING DIMENSIONS

Height (mm)	Width (mm)	Depth (mm)	Gross Wgt Kg
140	722	515	10

### PACKAGING DATA

Box Colour	Brown Cardboard Box - Printed		
Box Qty	1	Label Colour	White Label
Label Size	100 x 50	Label Qty	2

### OUTER BOX DIMENSIONS (If Applicable)

Height (mm)	Width (mm)	Depth (mm)	Gross Wgt Kg
Barcode		5055275832462	

### PRODUCT DETAILS

Country of Origin	Poland
Fitting Instruction	No

Certification	CE	N/A	WRAS	N/A	WRAS Number	N/A
Product Material	Polymarble					

### PANS/BIDETS

Trap Style	Not Applicable	Includes Seat	Not Applicable
------------	----------------	---------------	----------------

### CISTERNS

Fittings	Not Applicable	Operating Type	Not Applicable
Lever Type	Not Applicable		

### SEAT

Type	Not Applicable	Function	Not Applicable
Material	Not Applicable		
Hinge Type	Not Applicable	Hinge Material	Not Applicable

### BASINS

Tap Hole	One Taphole	Chain Stay Hole	No
Template	Not Required	Waste Type Req'd	Slotted
Overflow Incl.	Yes	Overflow Cover	Yes
Inner Bowl Depth	110mm		

### GENERAL

Fixing Supplied	No
-----------------	----