

CLASSIC\_DOUBLE\_BELFAST FIRE/CLAY CERAMIC  
BELFAST SINK  
CDB800WH/



Size: 800 x 500 mm  
Featuring two large bowls, the Classic double bowl Belfast kitchen sink embraces the classic good looks of a classic Belfast-style sink whilst offering ample space for food preparation and washing up.

- Waste kit sold separately
- 10 year warranty



Material	Fire/clay Ceramic
Material Gauge	-
Material Finish Bowl	-
Material Finish Drainer	-
Drainer Position	—
Overall Length (mm)	800
Overall Width (mm)	500
Main Bowl Length (mm)	445
Main Bowl Width (mm)	360
Main Bowl Depth (mm)	185
Second Bowl Length (mm)	445
Second Bowl Width (mm)	360
Second Bowl Depth (mm)	185
Tap hole Size (mm)	-
Waste Size (mm)	2 x 89
Waste Kit:	Sold separately, please order WKIT24/
Min. Base Unit (mm)	800
Cutout Size Length (mm)	-
Cutout Size Width (mm)	-
Warranty Sinks (years)	10
Product Code	CDB800WH/
Barcode	5015834043265

Date of download: May 31, 2021

AGA Rangemaster continuously seeks improvements in specification, design and production of products and thus, alterations take place periodically. Whilst every effort is made to produce up to date resources, the information included here is intended as a guide. Always refer to the installation instructions when fitting, installation work should be completed by a professional tradesman.

CLASSIC\_DOUBLE\_BELFAST FIRE/CLAY CERAMIC  
BELFAST SINK  
CDB800WH/  
Technical Drawing

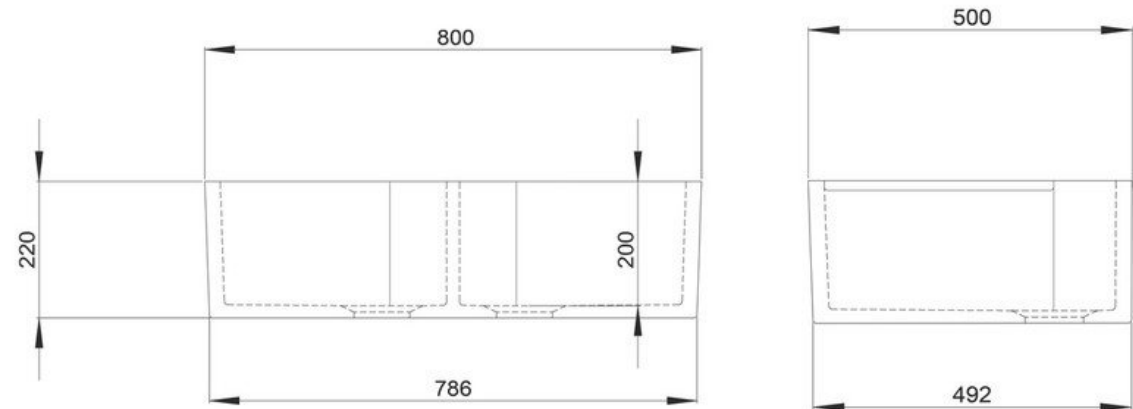
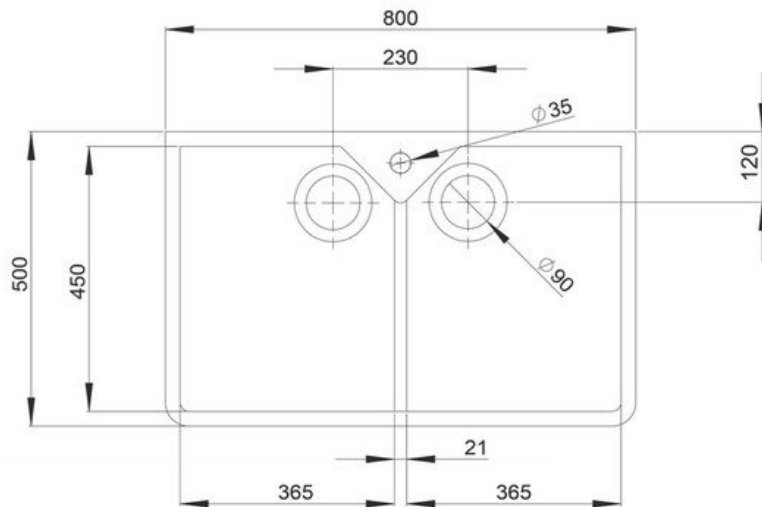

NB. Due to manufacturing processes this sink may have a dimension tolerance as follows  
Dimension Tolerance - Less Than 75mm  $\pm 5\%$   
- Greater Than 75mm  $\pm 2\%$

Date of download: May 31, 2021

AGA Rangemaster continuously seeks improvements in specification, design and production of products and thus, alterations take place periodically. Whilst every effort is made to produce up to date resources, the information included here is intended as a guide. Always refer to the installation instructions when fitting, installation work should be completed by a professional tradesman.

# CLASSIC\_DOUBLE\_BELFAST FIRE/CLAY CERAMIC BELFAST SINK CDB800WH/