

# SensoWash® Starck f Plus

**Bedienungsanleitung**

Compact Dusch-WC

**Operating instructions**

Compact shower toilet

**Notice d'utilisation**

WC douche compact

**Gebruikshandleiding**

Compacte douche-WC

**Manual de instrucciones**

Inodoro con lavado compacto

**Istruzioni d'uso**

Vaso compatto con sedile elettronico

Kleben Sie das beiliegende Produkt-Etikett mit der Seriennummer in dieses Feld.

Affix the enclosed product label with serial number in this area.

Collez l'étiquette de produit ci-jointe avec le numéro de série dans ce champ.

Plak het bijgevoegde product-etiket met het serienummer in dit veld.

Pegue la etiqueta de producto suministrada con el número de serie en esta casilla.

Incollare in questo spazio l'etichetta del prodotto in dotazione con il numero di serie.

Order-Nr. 57314/19.071.1 · We reserve the right to make technical improvements and enhance the appearance of the products shown.

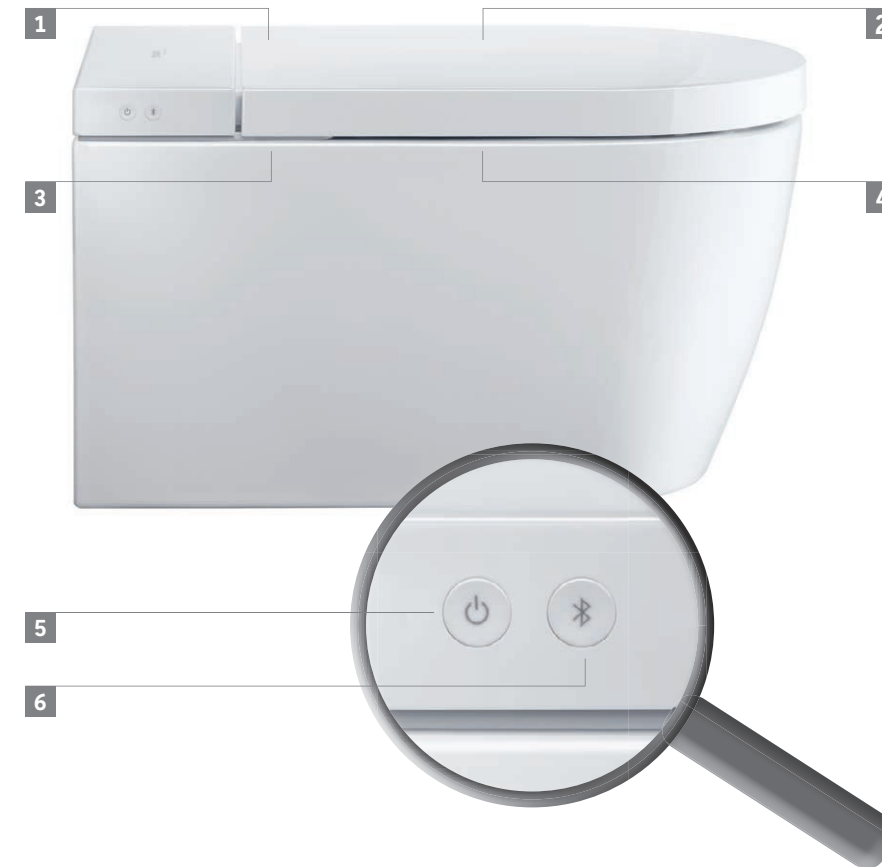

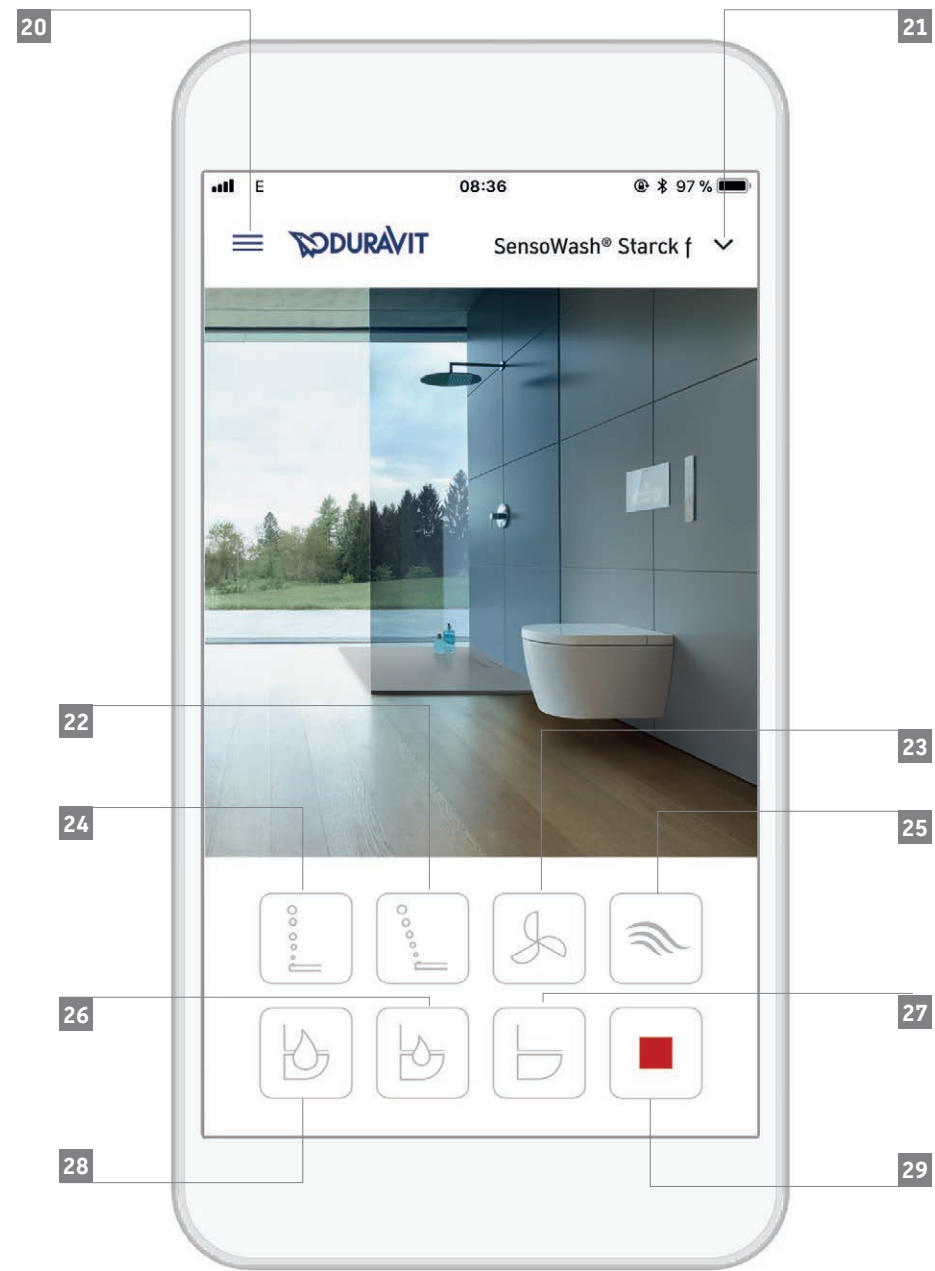

[www.sensowash.com](http://www.sensowash.com)

# Contents

<b>1. Brief overview</b>	<b>32</b>
<b>1.1 Toilet unit</b>	<b>32</b>
<b>1.2 Remote control</b>	<b>32</b>
<b>1.3 App</b>	<b>32</b>
<b>1.4 Functional area</b>	<b>33</b>
<b>1.5 Descaling connection</b>	<b>33</b>
<b>2. Description of symbols</b>	<b>34</b>
<b>3. For your safety</b>	<b>35</b>
<b>3.1 Normal use</b>	<b>35</b>
<b>3.2 Safety instructions</b>	<b>35</b>
<b>4. Basic product information</b>	<b>39</b>
<b>4.1 About this manual</b>	<b>39</b>
<b>4.2 Operation</b>	<b>39</b>
<b>4.3 LED indication</b>	<b>41</b>
<b>4.4 Energy saving and water efficiency</b>	<b>42</b>
<b>5. Initial operation</b>	<b>42</b>
Switch SensoWash® on/off	42
Download app	43
Pairing app	43
Change batteries	43
<b>6. Operating</b>	<b>44</b>
Open/close lid	44
Activate/deactivate Rearwash	45
Activate/deactivate Ladywash	45
Activate/deactivate warm air dryer	46
Adjust spray wand position	46
Adjust water spray intensity	47
Adjust water temperature	47
Set user profile	48
Activate user profile	48
Activate flushing functions (optional)	48
Activate/deactivate odor extraction (optional)	48
<b>7. Cleaning and care</b>	<b>49</b>
Cleaning recommendations	49
Manual cleaning mode (spray wand and nozzle)	50
Self-cleaning (spray wand and nozzle)	51

Holiday mode.....	51
Descaling.....	51
<b>8. Disposal .....</b>	<b>52</b>
<b>9. Troubleshooting support .....</b>	<b>52</b>
<b>10. Technical data .....</b>	<b>55</b>

# 1. Brief overview

## 1.1 Toilet unit

- 1 Seat sensor
- 2 Auto opening lid
- 3 Seat heating
- 4 Night light
- 5 Power/status indication (LED)
- 6 Bluetooth

## 1.2 Remote control

- 7 User profile 1
- 8 User profile 2
- 9 Full flush\*
- 10 Eco flush\*
- 11 Rearwash
- 12 Ladywash
- 13 Odor extraction\*
- 14 Warm air dryer
- 15 Water temperature
- 16 Water spray intensity
- 17 Spray wand position
- 18 Open/close lid
- 19 Stop

## 1.3 App

- 20 Menu
- 21 Add/delete device
- 22 Ladywash
- 23 Warm air dryer
- 24 Rearwash
- 25 Odor extraction\*
- 26 Eco flush\*
- 27 Open/close lid
- 28 Full flush\*
- 29 Stop

EN

\*Only in combination with DuraSystem® installation frame and A2 actuator plate.

## 1.4 Functional area

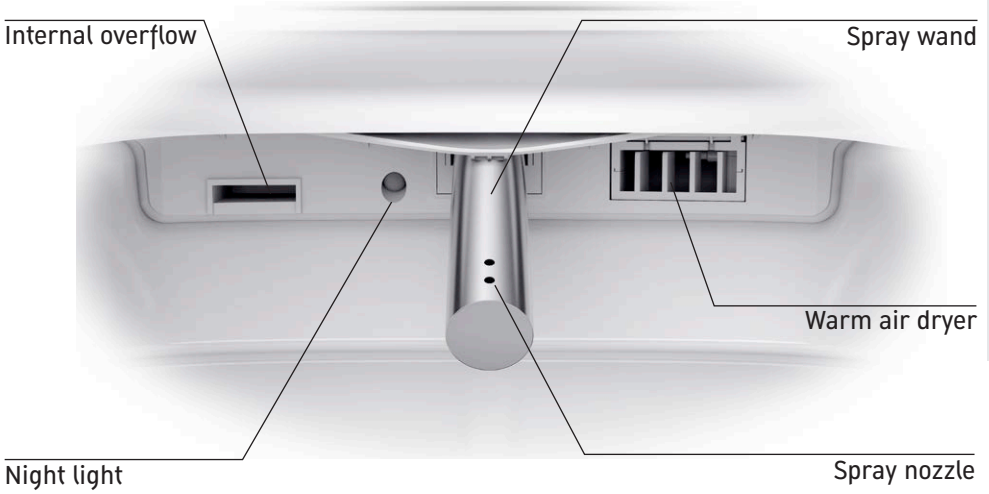

## 1.5 Descaling connection

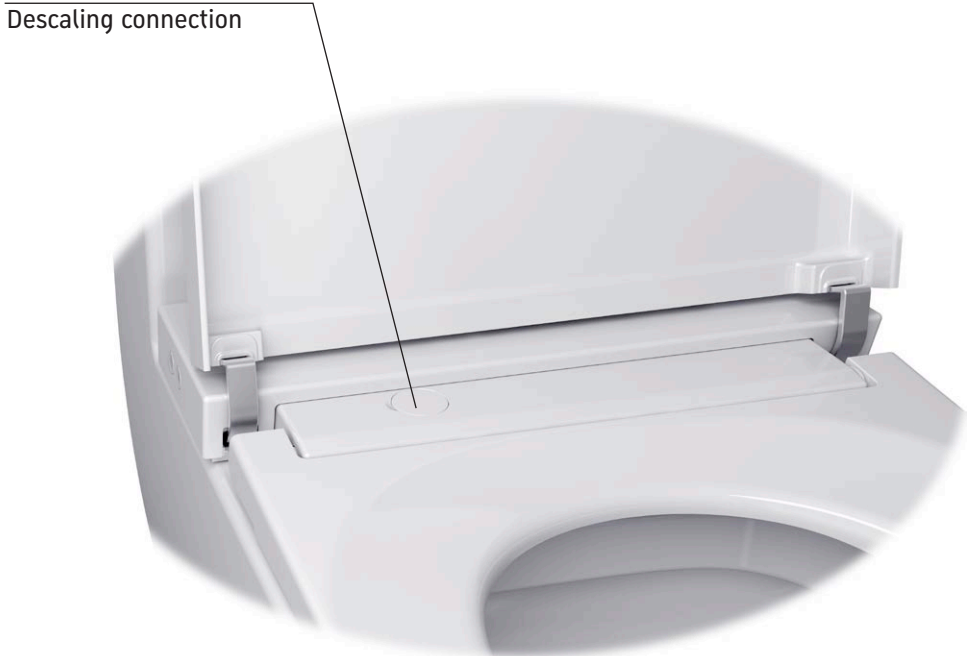

## 2. Description of symbols

The following warning signs warn you of dangerous situations and their severity:



Indicates a hazardous situation which, if not avoided, could result in death or serious injury.



Indicates a hazardous situation which, if not avoided, may result in minor or moderate injury.



Addresses practices not related to physical injury.

EN

The following symbols are used:

**i** Hints and tips are provided here.

**>** This is a prompt requesting your input.



Functions/settings controlled on seat unit.



Functions/settings controlled via remote control.



Functions/settings controlled via app.

## 3. For your safety

To ensure that you will enjoy your SensoWash®, read these operating instructions carefully, particularly the safety instructions. Keep the operating instructions in a safe place and in the case of a change in ownership, ensure they are given to the new owner. These operating instructions correspond to the device's state of technology at the time of printing. Duravit reserves the right to make changes in terms of further development.

### 3.1 Normal use

SensoWash® is a shower toilet with spray attachment for Rearwash and Ladywash cleansing functions and additional comfort features. Its use is limited exclusively to enclosed spaces. Any other usage will be deemed as not corresponding with normal usage. Duravit undertakes no liability for abnormal usage.

### 3.2 Safety instructions

Read and observe the following safety instructions carefully!

#### Requirements for the user

This appliance is not intended for use by persons (including children) with reduced physical, sensory or mental capabilities, or lack of experience and knowledge, unless they have been given supervision or instruction concerning use of the appliance by a person responsible for their safety.

> Children should be supervised to ensure that they do not play with the appliance.



**WARNING**

#### **Damage to health caused by electric shock and/or product damage**

> The product must be earthed. Compare with the mounting instructions.

#### **Only use the device when it is fully functional.**

- > Make sure that the power cord is not damaged.
- > The power cord must not become jammed or pinched.
- > Keep the power cord away from hot surfaces and sharp edges.



**Do NOT use the product if it is not working properly.**

- > Disconnect from the power supply immediately. Close the stop valve to interrupt the water supply. Contact [help@duravit.com](mailto:help@duravit.com).
- > Avoid malfunctions and damage to the product as a result of improper use.



**CAUTION**

**Health damage and potential product damage!**

- > Supply the device with cold drinking water from the main water system.
- > The new hose-sets supplied with the appliance are to be used and old hose-sets should not be reused.
- > The product itself does not have electrical leakage protection function, it must be installed in circuit where there is leakage protection device installed.
- > Means for disconnection must be incorporated in the fixed wiring in accordance with the wiring rules and having a contact separation in all poles that provide full disconnection under overvoltage category III conditions.
- > Do NOT sit, stand or lean on the lid.
- > Do NOT connect any waste water, grey water, industrial water, sea water or other untreated or semi-treated water.
- > Do NOT detach seat and lid for any purpose.
- > Do NOT damage the surface of seat. If the surface of the seat is damaged, contact [help@duravit.com](mailto:help@duravit.com).
- > DO NOT open and close seat with excessive force.
- > Open and close the lid via remote control and app only. Do not open and close the lid manually.
- > If the SensoWash® is moved from a cold location to a warm location, condensation may form. Leave the unit switched off for a few hours.
- > Do NOT install the SensoWash® in rooms where there is a danger of frost. The room temperature must not be less than 4°C (39°F).
- > Do NOT place open fire sources, candles, cigarettes, or similar, on the SensoWash®.
- > Do NOT expose the SensoWash® directly to water or sunlight.
- > Do NOT climb on or stand on the product.
- > Do NOT place any heavy objects on the lid.
- > Do NOT deliberately soil, spray or block the spray wand.

## **Repairs must only be carried out by a person with the necessary expertise and qualification.**

- > Do NOT carry out modifications, tamper with, install additional equipment or attempt to repair the SensoWash®.
- > If the supply cord is damaged, it must be replaced by the manufacturer, its service agent or similarly qualified persons in order to avoid a hazard.
- > Repairs must be carried out by qualified electricians or technicians.
- > Improperly performed repairs can lead to accidents, damage and malfunctions.
- > Do NOT use attachments not recommended by Duravit.

EN

## **Use of batteries**



### **WARNING**

#### **Risk of fatal injury if swallowed/Chemical burn hazard**

This product contains coin/button cell batteries. Do not ingest battery! If the cell battery is swallowed, it can cause severe internal burns in just 2 hours and can lead to death.

- > Do not ingest battery, Chemical Burn Hazard.
- > Keep new and used batteries away from children. If the battery compartment does not close securely, stop using the product and keep it away from children.
- > If you think batteries might have been swallowed or placed inside any part of the body, seek immediate medical attention.



### **CAUTION**

#### **Damage to health caused by leaking battery acid**

- > Avoid contact with skin, eyes and mucous membranes if battery acid has leaked.
- > In case of contact with the acid, flush the affected areas with large amounts of clean water and consult a doctor immediately.
- > Do not expose the batteries to extreme conditions: avoid contact with hot surfaces or direct sunlight. Otherwise there is a risk of leakage.
- > The cells shall be disposed of properly, including keeping them away from children. Even used cells may cause injury.

**NOTICE****Product and/or property damage**

- > Batteries may not be recharged, reactivated by other means, dismantled or exposed to fire.
- > The supply terminals are not to be short-circuited.
- > Always remove empty batteries from the remote control immediately. They may leak and cause damage.
- > Do not insert new and old batteries together in the remote control.
- > Different types of batteries are not to be mixed.
- > Clean the battery and contacts before inserting the battery.
- > Batteries are to be inserted with the right polarity.
- > Remove the batteries if you do not use the remote control for an extended period.

EN

## 4. Basic product information

### 4.1 About this manual

This manual contains safety and general product information and information on how to operate SensoWash® via remote control (basic setting range).

- > See Quick Guide in app (→ App: Menu - Device Guide - Quick Guide **20**) for information on the full range of setting options available for this product.

### 4.2 Operation

SensoWash® is operated via remote control (basic setting range) and/or app (extended setting range).

A number of settings can be adjusted via app only (→ Table: Functions and settings).

- > Download app to adjust the full range of setting options available for this product (→ Ch. 5: Download app).

EN

#### Functions and Settings



The full range of functions is available whether the product is operated via remote control or app. Functions are set according to default settings (→ Table: Default settings). Download app to make adjustments on the extended setting range (→ Ch. 5: Download app).

#### Controlled via



basic range

extended range

			
		basic range	extended range
On/off SensoWash®	•	-	-
Bluetooth (connect app)	•	-	-
Open/close lid (electromotive)	-	•	•
Auto opening lid	-	-	•
Auto closing lid	-	-	•
Full flush	-	•*	•*
Eco flush	-	•*	•*
Rearwash	-	•	•
Ladywash	-	•	•
Comfortwash	-	-	•
Warm air dryer	-	•	•
Warm air dryer temperature	-	-	•

## Functions and Settings

### Controlled via



basic range

extended range

Spray wand position	-	•	•
Water spray intensity	-	•	•
Water temperature	-	•	•
Odor extraction	-	•*	•*
User profile	-	•	-
Seat heating	-	-	•
Seat heating temperature	-	-	•
Energy saving (seat heating)	-	-	•
Night light	-	-	•
Confirmation tone	-	-	•
Holiday mode	-	-	•
Manual cleaning mode	-	-	•
Self-cleaning	-	-	•
Descaling	-	-	•
Reset default setting	-	-	•

Table: Functions and settings

\*Only in combination with DuraSystem® installation frame and A2 actuator plate.

<b>Default Settings</b>		
	setting range	default setting
Auto opening lid	on/off	off
Auto closing lid	on/off	off
Comfortwash	on/off	on
Warm air dryer temperature	off/low/medium/high	medium
Spray wand position	front 1, 2, 3, 4, 5 back	3
Water spray intensity	low/medium/high	medium
Water temperature	off/low/medium/high	medium
Seat heating	on/off	on
Seat heating temperature	low/medium/high	medium
Energy saving mode	on/off	off
Night light	off/auto/on	auto
Confirmation tone	on/off	off

Table: Default settings

### 4.3 LED indication

<b>Power button</b>	
Red light	Indicates stand-by mode. Switch SensoWash® on to activate seat unit (→ Ch. 5: Switch SensoWash® on/off).
Green light	Indicates on mode. Energy saving mode is off.
Orange light	Indicates on mode. Energy saving mode is on.
Flashing	Malfunction. Deactivate seat unit, close stop valve, contact help@duravit.com (→ Ch. 9: Troubleshooting).
<b>Bluetooth button</b>	
Blue light	Bluetooth is available or connected.
Off	Bluetooth is not available.
Flashing	Device is in pairing mode (→ Ch. 5: Pairing app).

Table: LED indication (seat unit)

## 4.4 Energy saving and water efficiency

In order to minimize the cost of natural resources, SensoWash® includes an instant heating system and an Auto Stop feature for all washing and drying functions. To save energy in the everyday usage of the product, it is possible to adjust the following settings:

### > Energy saving mode (seat heating)

Deactivates seat heating for a specific period of time (e. g. during daytime, while at work) and automatically reactivates seat heating after that time (→ App: Menu - Settings - Seat **20** ).

### > Holiday mode

If you do not use SensoWash® for two weeks or above, drain the water and deactivate the product (→ Ch. 7: Holiday mode) (→ App: Menu - Care - Holiday mode **20** ).

EN

## 5. Initial operation

### Switch SensoWash® on/off

SensoWash® can be switched on/off via the side control button. Requirement: SensoWash® must be connected to the main power supply.

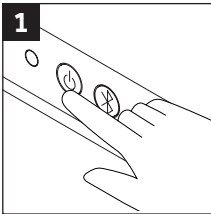

> Press button shown to switch seat on or off.

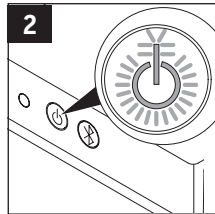

> Green LED: seat ready to use.  
> Red LED: seat not ready to use (standby).

## Download app

Search for "SensoWash" in Play Store (Android) or App Store (iOS).



## Pairing app

SensoWash® is connected to the app via bluetooth. SensoWash® and bluetooth have to be switched on (→ **5** and **6** ) to establish the connection. Follow step-by-step instructions in app to connect app to the product.

EN

## Change batteries

Insert batteries into the remote control.

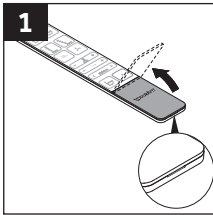

- > Remove screw and open battery compartment.

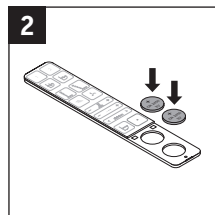

- > Insert batteries (CR2450).

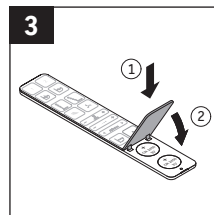

- > Close battery compartment.

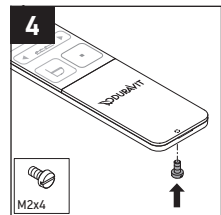

- > Attach screw.



## 6. Operating



Use this QR-Code to see a video of the operating functions or visit [www.duravit.com/vid\\_sensowash\\_starck\\_f](http://www.duravit.com/vid_sensowash_starck_f)

EN



### Open/close lid

The SensoWash® lid opens/closes automatically when a person approaches/leaves the toilet. Alternatively open/close lid via remote control or app.

#### NOTICE

#### Damage of seat and lid!

Lid can be damaged if it is opened/closed manually.

- > Open and close lid via remote control or app only.
- > Do not open and close the lid manually.
- > Do NOT open and close seat with excessive force.

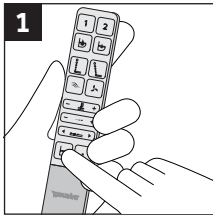

- > Press icon shown to open or close lid.



Open/close lid

Auto opening (activate/deactivate)

Auto closing (activate/deactivate)



## Activate/deactivate Rearwash

Gentle and safe rear cleansing.

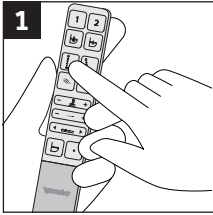

> Press icon shown to activate Rearwash.

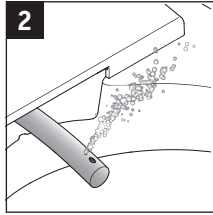

> Rearwash is active, the spray wand extracts slowly.

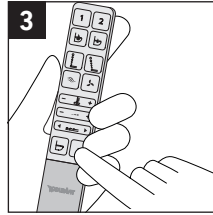

> Press stop to end or after 2 min. auto stop.

**i** SensoWash® automatically cleans the retracted spray wand when the seat sensor is activated and also before and after washing functions are used.



Rearwash (activate/deactivate)

Adjust spray wand position, adjust water spray intensity, adjust water temperature

Comfortwash (activate/deactivate)



## Activate/deactivate Ladywash

Spray wand functions for feminine cleansing.

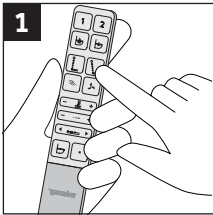

> Press icon shown to activate Ladywash.

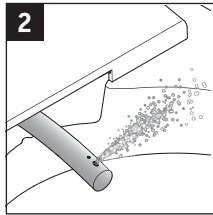

> Ladywash is active, the spray wand extracts slowly.

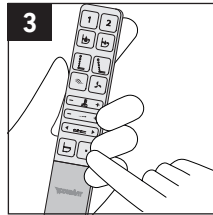

> Press stop to end or after 2 min. auto stop.

**i** SensoWash® automatically cleans the retracted spray wand when the seat sensor is activated and also before and after washing functions are used.



Ladywash (activate/deactivate)

Adjust spray wand position, adjust water spray intensity, adjust water temperature

Comfortwash (activate/deactivate)



## Activate/deactivate warm air dryer

Pleasant drying through warm air after washing function.

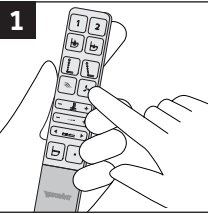

1

> Press icon shown to activate dryer.

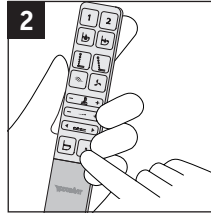

2

> Press stop to end or after 5 min. auto stop.



Warm air dryer (activate/deactivate)

Warm air dryer temperature



## Adjust spray wand position

Spray wand position can be set individually to 5 different positions (front 1, 2, 3, 4, 5 back).

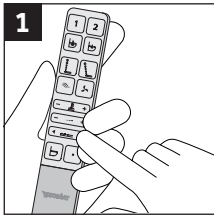

1

> Press right arrow to move spray wand back.

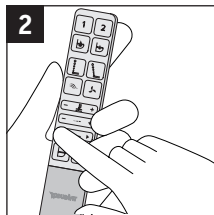

2

> Press left arrow to move spray wand to the front.

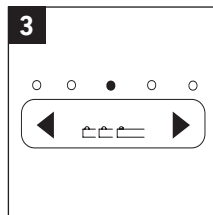

3

> LEDs indicate setting.



Adjust spray wand position (Rearwash)

Adjust spray wand position (Ladywash)



## Adjust water spray intensity

Water spray intensity can be set individually to 3 different levels (low/medium/high).

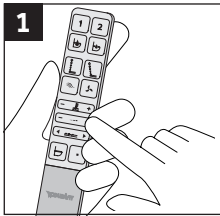

> Press plus to increase spray intensity.

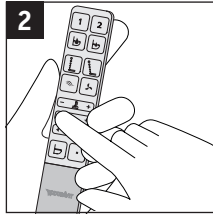

> Press minus to decrease spray intensity.

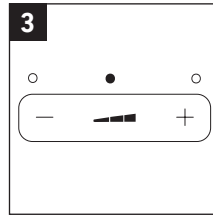

> LEDs indicate setting.



Adjust water spray intensity (Rearwash)  
Adjust water spray intensity (Ladywash)



## Adjust water temperature

Water temperature can be set individually to 4 different levels (off/low/medium/high).

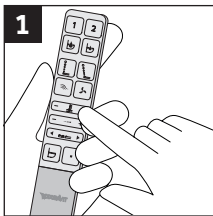

> Press plus to increase water temperature.

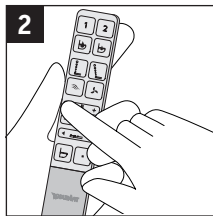

> Press minus to decrease water temperature.

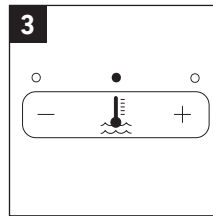

> LEDs indicate setting.

**i** If you choose level off, the water has the temperature of inlet water and the LEDs are off.



Adjust water temperature (Rearwash)  
Adjust water temperature (Ladywash)

1

2

## Set user profile

Personal preferences can be stored in different user profiles.

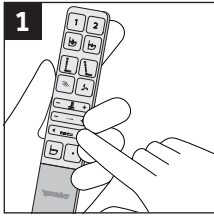

> Adjust spray wand position.

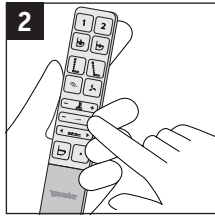

> Adjust water spray intensity.

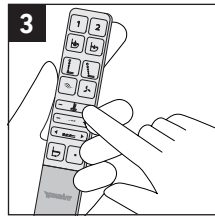

> Adjust water temperature.

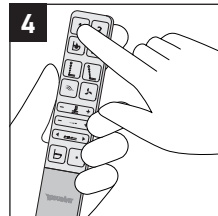

> Press 1/2 for 3 sec. to save profile.

EN

1

2

## Activate user profile

Activate set preferences.

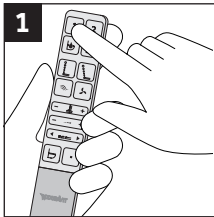

> Press 1/2 to activate profile.

**i** LEDs on the remote control indicate which settings are stored.



## Activate flushing functions (optional)

The flushing functions can be activated via app and remote control but only in combination with DuraSystem® installation frame and A2 actuator plate.



Flushing function (activate/deactivate)



## Activate/deactivate odor extraction (optional)

Odor extraction can be activated/deactivated via app and remote control but only in combination with DuraSystem® installation frame and A2 actuator plate.



Odor extraction (activate/deactivate)

## 7. Cleaning and care

### Cleaning recommendations

#### **WARNING** Health damage!

- > Switch off SensoWash® before starting the cleaning (→ Ch. 5: Switch SensoWash® on/off).
- > Do NOT allow water to seep inside the product.

#### **NOTICE** Damage to surface due to incorrect cleaning.

Abrasive or aggressive cleaning agents may damage and/or scratch the surface. Incorrect cleaning agents can lead to discoloration.

- > Use cleaning agent recommended by Duravit (→ Table: Cleaning recommendations) and a soft cleaning cloth.

Spray can penetrate into very small openings and gaps and damage the surface.

- > Spray the spray cleaner onto the cleaning cloth and not directly onto the product.

If the cleaning is not carried out regularly, soiling may become more difficult to remove.

- > Regularly clean the surface and clean immediately if soiled.

EN

## Cleaning recommendations

Surface	Cleaning agent	Equipment	Cleaning
Ceramic (daily cleaning)	acidic vinegar or citrus based cleaning agent (pH 1 – 4)	cloth, sponge or brush	<ul style="list-style-type: none"><li>&gt; Clean the surface with a soft damp cloth.</li><li>&gt; Remove heavier soiling with warm water and recommended cleaning agent that you apply to the cloth/sponge/brush.</li><li>&gt; Then wipe with a damp cloth to remove all traces of the cleaning agent.</li><li>&gt; Dry the surface.</li></ul>
Ceramic (stubborn dirt)	stainless steel cleaner, car polish or a ceramic hob cleaner	cloth, sponge or brush	
Spray wand and nozzle	mild cleaning agent (pH 7) without hydrochloric acid or chloride	cloth, sponge or brush	
Seat and lid	mild cleaning agent (pH 7) without hydrochloric acid or chloride	soft, damp cloth	
Cover	mild cleaning agent (pH 7) without hydrochloric acid or chloride	soft, damp cloth	
Remote control	water	soft, damp cloth	

Table: Cleaning recommendations

## Manual cleaning mode (spray wand and nozzle)

Manual cleaning is only possible if the seat sensor is not activated.

- > Activate manual cleaning mode via app to extract the spray wand for manual cleaning.



Manual cleaning mode (spray wand and nozzle)

## Self-cleaning (spray wand and nozzle)

SensoWash® automatically cleans the retracted spray wand when the seat sensor is activated and also before and after washing functions are used.

- > Activate additional self-cleaning via app.



Self-cleaning (Spray wand and nozzle)

## Holiday mode

If you do not use SensoWash® for two weeks or above, drain the water inside the product.

- > Disconnect water supply.
- > Activate holiday mode via app (→ App: Menu - Care - Holiday mode **20** ).
- > Switch off the power supply.
- > Remove the batteries from the remote control (→ Ch. 5: Change batteries).



Holiday mode

## Descaling

### NOTICE

#### Product damage due to limescale build-up

In regions with hard water, limescale build-up can impair the performance of the product.

- > Check the water quality in your region. Duravit recommends the installation of a water softener with water hardness  $\geq 14^\circ$  dH (2.5 mmol/l).
- > Make sure to descale the product regularly (→ Table: Descaling cycles). The app will send an automatic reminder. Adjust the descaling settings according to the water hardness in your region (→ App: Menu - Care - Descaling **20** ).
- > Only use descaling agents provided or approved by Duravit.

Water hardness		Descaling cycle
soft	$<8.4^\circ$ dH (1.5 mmol/l)	every six months
moderate	$8.4 - 14^\circ$ dH (1.5 - 2.5 mmol/l)	every six months
hard	$>14^\circ$ dH (2.5 mmol/l)	quarterly

Table: Descaling cycles



The descaling process can be activated via app.

> Follow the instructions provided in the app.



Descaling

---

## 8. Disposal



The crossed-out wheeled bin logo requires the separate collection of waste electric and electronic equipment (WEEE). Electric and electronic equipment

may contain dangerous and hazardous substances. Do not dispose of this appliance as unsorted municipal waste. Return it to a designated collection point for the recycling of WEEE. By doing so, you will help to conserve resources and protect the environment. Contact your retailer or local authorities for more information.

Used batteries must be disposed of properly. For this purpose, appropriately labelled containers for disposal of batteries are provided in shops where batteries are sold and at community collection points.

Children must not play with plastic bags and packaging material, due to possible injury or danger of suffocation. Store such material safely or dispose of it in an environmentally-friendly manner. If possible, keep the packaging until the warranty period expires.

## 9. Troubleshooting support

Initial general action in case of a malfunction: Please switch off the unit and then switch it on again (→ Ch. 5: Switch SensoWash® on/off).

If your unit does still not work properly after following the instructions mentioned below, contact [help@duravit.com](mailto:help@duravit.com). Have the article and serial number ready. These can be found on the nameplate on the back of the operating instructions and in the app (→ App: Menu - Device guide - Device management - Device information).

Problem	Potential cause	Solution	Ch.
<b>LED indications</b>			
LED flashes red, green or orange or an indication tone is audible.	Malfunction.	<ul style="list-style-type: none"> <li>&gt; Deactivate seat unit.</li> <li>&gt; Close stop valve.</li> <li>&gt; Contact Duravit help@duravit.com.</li> </ul>	5 1.5
<b>General problems</b>			
Unit does not work.	Seat unit is in standby mode (LED is red).	<ul style="list-style-type: none"> <li>&gt; Switch on seat unit.</li> </ul>	5
Water leakage.	Malfunction.	<ul style="list-style-type: none"> <li>&gt; Close the main valve for the water supply.</li> <li>&gt; Disconnect the power supply.</li> <li>&gt; Contact help@duravit.com.</li> </ul>	
<b>Remote Control</b>			
White LED blinks for 3 sec. when RC is in use.	The batteries are low.	<ul style="list-style-type: none"> <li>&gt; Change the batteries.</li> </ul>	5
LED flashes red when RC is in use.	Remote control is not connected to the product.	<ul style="list-style-type: none"> <li>&gt; Contact help@duravit.com.</li> </ul>	
Remote control does not work.	No batteries inserted.	<ul style="list-style-type: none"> <li>&gt; Insert batteries.</li> </ul>	5
	Remote control is defect.	<ul style="list-style-type: none"> <li>&gt; Contact help@duravit.com.</li> </ul>	
<b>Washing functions</b>			
Switch between Rearwash/Ladywash takes too long.	Spray wand moves back and forward again after self-cleaning is complete.	This is normal.	
Water spray intensity too weak.	Water spray intensity has been set to low.	<ul style="list-style-type: none"> <li>&gt; Adjust water spray intensity to medium or high.</li> </ul>	6 App
	Water supply defect.	<ul style="list-style-type: none"> <li>&gt; Contact help@duravit.com.</li> </ul>	
Water too warm/cold.		<ul style="list-style-type: none"> <li>&gt; Adjust water temperature.</li> </ul>	6 App
Water spray from the spray wand suddenly stops.	Function stops automatically after 2 min.	This is normal.	
	Seat sensor has lost contact.	<ul style="list-style-type: none"> <li>&gt; Sit down and select the function again.</li> </ul>	

<b>Problem</b>	<b>Potential cause</b>	<b>Solution</b>	<b>Ch.</b>
Water does not emerge from the spray wand.	The spray nozzle is clogged.	> Clean the spray nozzle.	7
	Seat sensor has lost contact.	> Sit down and select the function again.	
<b>Heated seat</b>			
Seat heating does not work.	Seat heating is switched off.	> Activate seat heating.	App
Seat temperature too warm/cold.		> Adjust seat heating temperature.	App
Seat temperature too cold.	Product is in energy saving mode (orange LED).	This is normal. > Switch off energy saving mode to heat seat.	App
	Product automatically switches to auto energy saving mode if all functions are inactive for 48 h.	> Activate any function to reactivate previous settings.	
<b>Warm air dryer</b>			
Warm air dryer too warm/cold.		> Adjust warm air dryer temperature.	App
Dryer function suddenly stops.	Function stops automatically after 5 min.	This is normal.	
	Seat sensor has lost contact.	> Sit down and select the function again.	
<b>Night light</b>			
Night light does not work.	Night light is switched off.	> Set the night light to Auto or on mode.	App
	Night light is in Auto mode and the ambient light is bright.	This is normal.	
Night light stays on continuously.	Night light is switched on.	This is normal. > Set the night light to Auto mode.	App
	Night light is in Auto mode and the ambient light is dim.	This is normal.	
<b>Manual Cleaning</b>			
The spray wand retracts automatically.	Function stops automatically after 2 min.	This is normal.	

Problem	Potential cause	Solution	Ch.
<b>Automatic Self-cleaning</b>			
Water dripping out of retracted spray wand.	The spray wand is cleaned automatically when the seat sensor is activated and before and after washing.	This is normal.	
<b>Lid</b>			
Lid does not open automatically when someone approaches.	Seat unit did not detect approaching person.	> Approach again (approx. 1 m distance).	
	Malfunction.	> Contact help@duravit.com.	
Lid does not close immediately	Lid closes automatically 90 sec. after leaving the toilet.	This is normal.	
<b>App</b>			
App does not work.	App and product are not connected.	> Connect product to app. > Make sure that pairing is successful.	5

EN

## 10. Technical data

Article number 650000 01 2 00 4320

Rated voltage 220 – 240 V

Frequency 50 – 60 Hz

Rated power 1080 W

Standby power < 0.5 W

Net weight 32.5 kg

Dimensions 376 x 578 x 405 mm

Temperature range

Operating temperature 4 – 40 °C

Water temperature 32 – 40 °C

Seat temperature 33 – 37 °C

Warm air dryer temperature 40 – 55 °C

Incoming water pressure	0.07 – 0.75 MPa (0.7 – 7.5 bar)
Water consumption in spray mode	0.35 – 0.60 l/min
Protection class	IP X4, Protection against water spray from all sides.
Integrated safety device	EN13076 - type AA
Warranty	Find our General Terms and Conditions (GTC) at <a href="http://www.pro.duravit.com/gtc">www.pro.duravit.com/gtc</a>
<b>EN</b> Radio Frequency Compliance Statement	<p>The bluetooth and microwave installed inside are in compliance with the essential requirements and other relevant provisions of RED Directive 2014/53/EU.</p> <p>&gt; Bluetooth Low Energy operating frequency bands: 2.402 – 2.480 GHz; Maximum radio-frequency power transmitted in the frequency bands in which the radio equipment operates is less than 2 mW.</p> <p>&gt; Microwave operating frequency bands: 24.05 – 24.25 GHz; Maximum radio-frequency power transmitted in the frequency bands in which the radio equipment operates is less than 16 mW.</p>