

FRONT OF WALL,
QUICK INSTALLATION
SYSTEM

CONCEALED
CISTERN
INSTALLATION AND
MAINTENANCE GUIDE

3/6 LITRES

FOR WALL
HUNG WC PANS



CONCEALED CISTERN SPECIFICATIONS

- The purchased Concealed Cistern gives more space in a bathroom with its small dimensions and allows to get installed easily,
- It has been tested and adapted in our modern labs according to French NF Standards which has been accepted as a reference in the world,
- Resistant to shock and temperature differences, produced by high density polyethylene material body with 3 mm thickness,
- The galvanized metal parts produced against the corrosion in the modern galvanne plants with the modern galvanne dipping methods,
- The metal chassis that capable of carrying 400 kg weight,
- Capable of working between 0,5-15 bar pressure, resistant to sudden pressure changes, filling group with float chamber,
- The silence discharging group adjusted to work 3/6 liters,
- Capable of working between 0-20 newton power, the control buttons that can be used easily by children and by elderly people,
- Inside mechanism kit that is simplified and easily can be installed and uninstalled without any error,
- The gasket and plastic parts are resistant against chemicals in the water,
- UV resistant white, matt chrome and polished chrome stylish and small control panels.

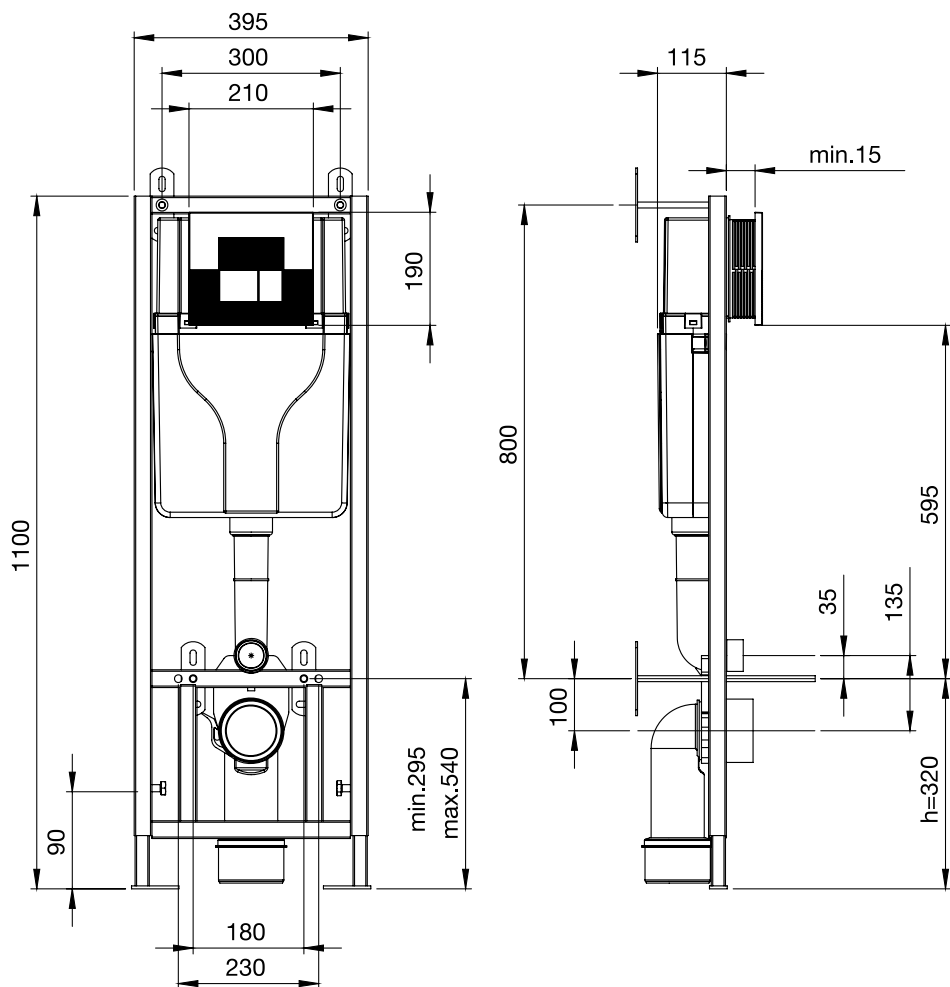

IMPORTANT NOTE:

Height (h) measurement means between the axis of the connection of the WC pan and the finished ground level and the average is 320 mm. However, definite measurement should be adjusted according to WC pan's connection axis.

- | | | | |
|-----------|------------------------------|-----------|--|
| 1 | Gauge Lid | 42 | Floater Pipe |
| 2 | Panel | 43 | Drip Tray |
| 3 | 3 Litres Button | 44 | Lever Gasket |
| 4 | 6 Litres Button | 45 | Lever Arm |
| 5 | Button Spring | 46 | Floater Bar |
| 6 | Screwed Bar | 47 | Screwed Adjusted Bar |
| 7 | Pressing Bar | 48 | Interior Tank Floater |
| 8 | 3 Litres Spring Clip | 49 | Exterior Tank Floater |
| 9 | 6 Litres Spring Clip | 50 | Below Floater Lid |
| 10 | Plastic Frame | 51 | Upper Body |
| 11 | Protector Lid | 52 | Lower Body |
| 12 | Moving Arm Cross Over | 53 | Body Gasket |
| 13 | Moving Arm | 54 | Clean Water Pipe |
| 14 | Clips | 55 | Waste Water 90 Degree Elbow |
| 15 | RYSB 4x20 Metal Screw | 56 | Adaptor Gasket |
| 16 | Gauge | 57 | Adaptor |
| 17 | Binding Flap | 58 | Body Isolation Styrofoam |
| 18 | Pulling Arm | 59 | Clean Water Pipe Gasket |
| 19 | Overflow Pipe | 60 | Waste Water Elbow Gasket |
| 20 | Discharge Styrofoam | 61 | Plastic Bracelets |
| 21 | Discharge Plate | 62 | Metal Chassis |
| 22 | Ring | 63 | M 10x25 Sharp Ended Bolt |
| 23 | Clip Gasket | 64 | Metal Leg |
| 24 | Outlet Valve Body | 65 | 8x65 Screw |
| 25 | Discharge Unit | 66 | M12 Nut |
| 26 | Discharge Unit Gasket | 67 | M10 Expanded Wall Plug |
| 27 | Discharge Unit O Ring | 68 | Interval Extension Pipe |
| 28 | Floater Arm | 69 | Interval Extension Pipe Gasket |
| 29 | 3 Litres Floater | 70 | Clean Water Stopper |
| 30 | Floater Styrofoam | 71 | Plain Pipe |
| 31 | Discharge Bridge | 72 | Plain Pipe Gasket |
| 32 | Tap Sponge | 73 | Waste Water Stopper |
| 33 | Interval Tap | 74 | Base with M12 Nut |
| 34 | Flexible Hose | 75 | Plastic Backstop |
| 35 | Floater Gasket | 76 | M12 Washer |
| 36 | Floater | 77 | M12 Nut |
| 37 | Floater Gasket Holder | 78 | Screw Lid |
| 38 | Filling Bridge | 79 | M12x300 Threaded Nut |
| 39 | Membrane Gasket | 80 | Base with M 10x200 Threaded Nut |
| 40 | Membrane Gasket Bolt | 81 | Floater Lid Nut |
| 41 | Floater Lid | 82 | Lever Arm Bolt |

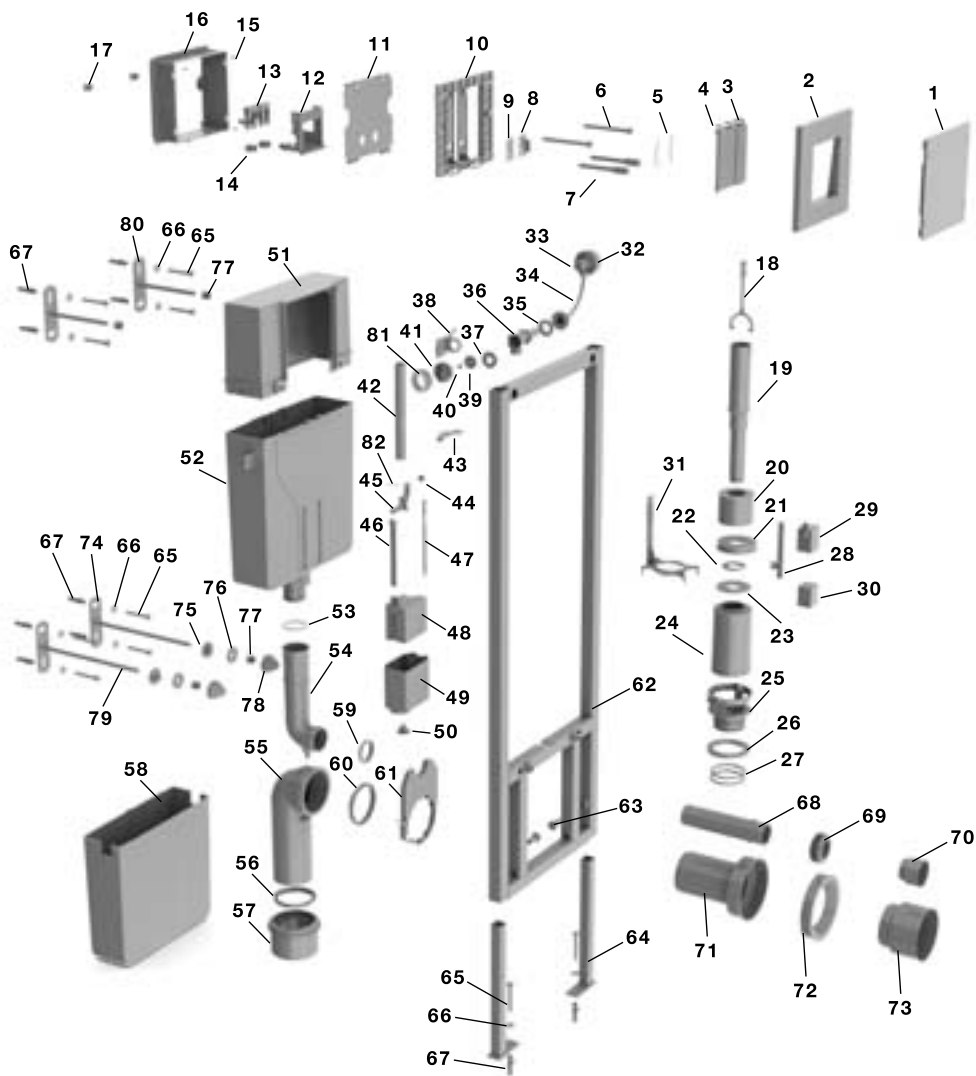

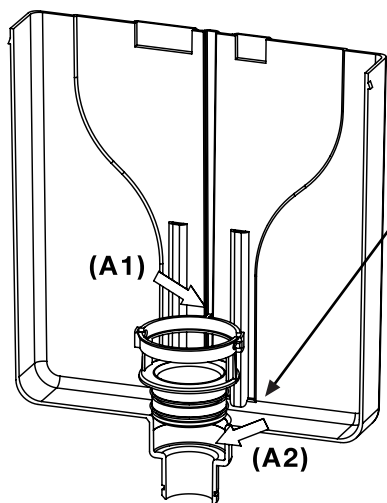

Installation of Discharging Unit

Place the pin that helps discharging unit to be installed correct way into it's place (A1) and (A2) press the arrow direction to install to clean water channel of the body.

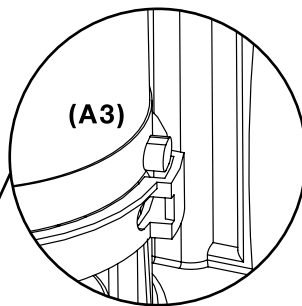
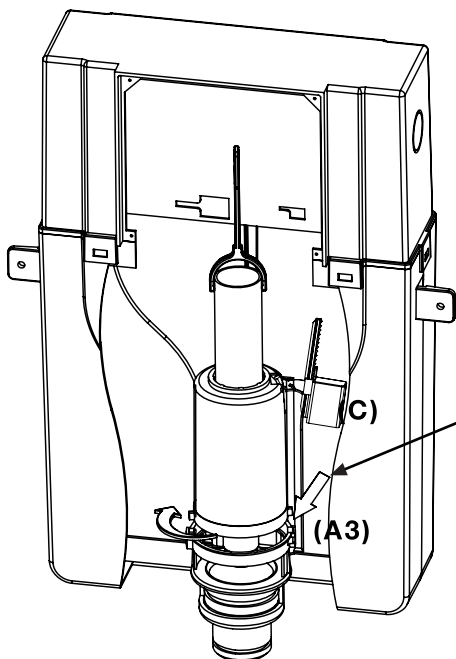
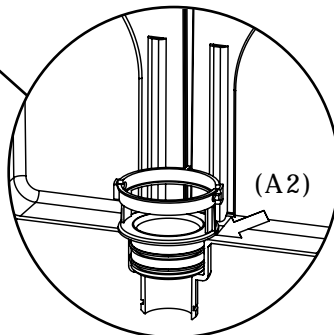

Installation of Discharging Group

After the installation of discharging group in to the body, lock the pin to it's place to the arrow direction.

Note: 3 litres floater should be on the right side (C).

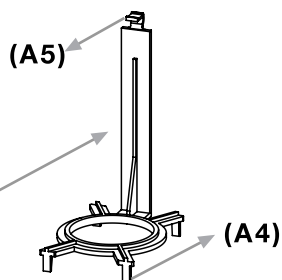
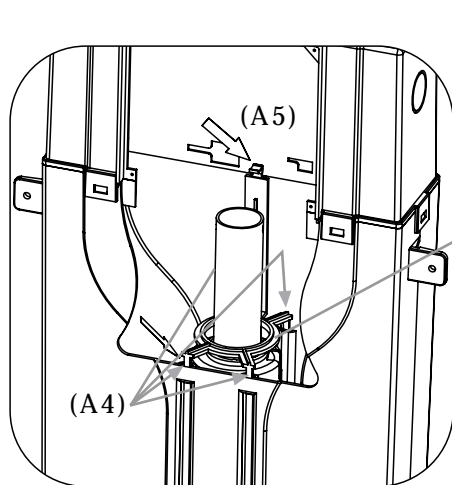

Place the bridge's holding clips (A4) to their places; the clips stabilize the discharging group to the body and help to protect against the impacts and push the pin (A5) with pressing by hand to the upper and lower body's connection point.

Filling Group Connection

Place the square pin to it's place by moving to the left side in order to fix the filling group to main body (A6). After fixing the filling group, squeeze the flex turnscrew (A7) for the clean water connection of the concealed cistern and connect the interval tap (A8) according to installation on the wall to the suitable upper, rear or side hole by opening.

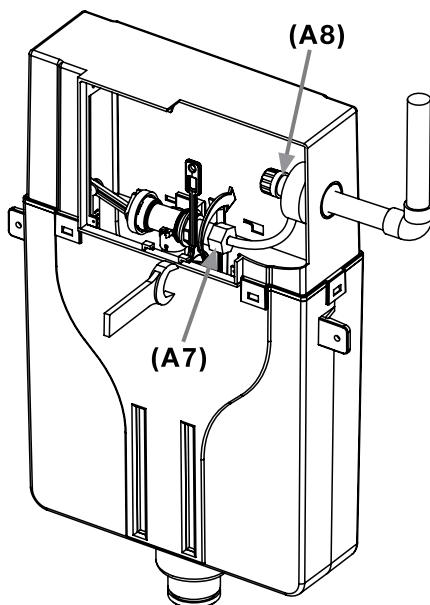
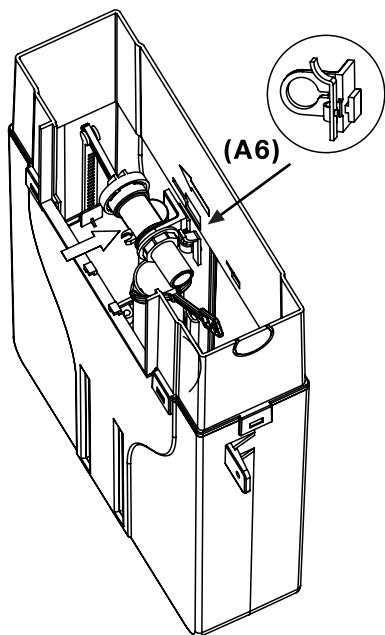

THE PROTECTIVE COVER AND THE FACE MOULD

INSTALLATION OF THE MOVING ARM BRIDGE

Place the moving arm bridge into it's place (1) by pushing on the main body then get through the channels (2) on the wide side of the body, fix the bridge (3) by pushing to the left side on the main body and mount the moving arm to pulling arm

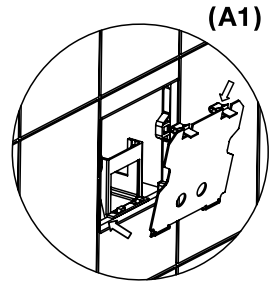
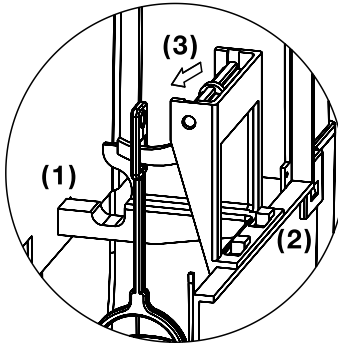
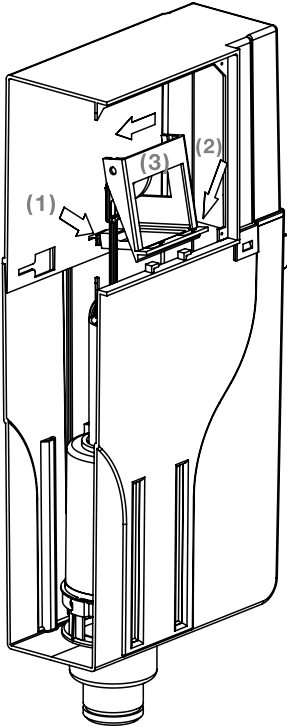

INSTALLATION OF THE PROTECTIVE COVER (A1)

Firstly, mount the protective cover (A1) to the bottom of the clips as it can be seen on the picture and then ensure the top pins locked.

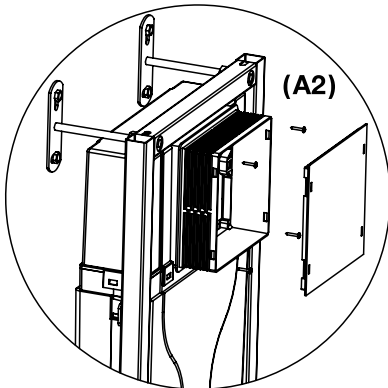

INSTALLATION OF THE FACE MOULD AND COVER (A2)

Fix the face mould by screwing to it's place on the main body in sequence and install the face mold cover (A2).

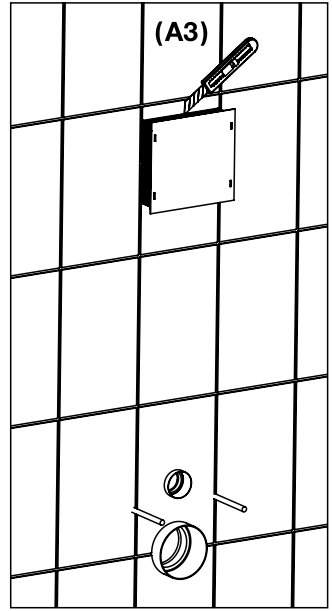
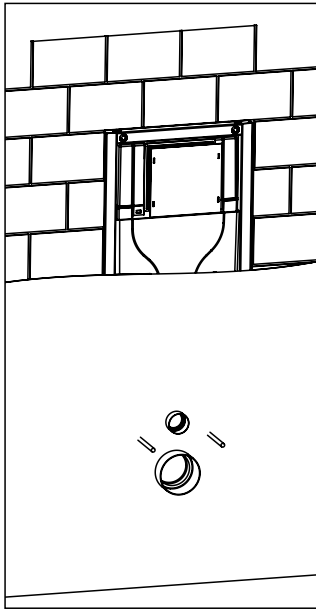
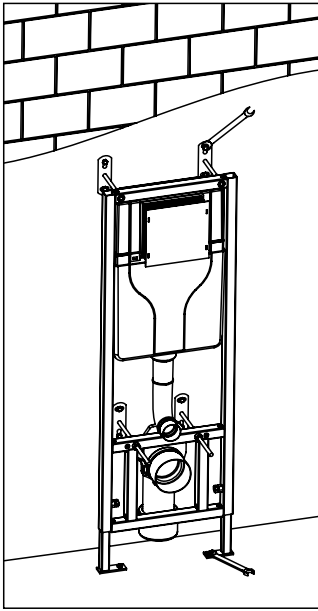

Place the concealed cistern to the installation place properly according to water system and waste water drainage. Arrange the installation height as it can be seen on the technical drawing. Ensure the flatness on the ground by using water gauge and then use the fixing screws to fit it to the wall and the floor. While doing the fixing process to the wall, make sure that the face mold, threaded nut pipes and waste and clean water's plug installed. After ceramic tiles installed, the face mold should be cut the same level as ceramic tile as it can be seen at figure A3. The control panel and WC pan connections should be done after above process. The face mold, the threaded nut pipes, the waste and the clean water plug, the control panels and the interval extension pipe are the installation face mold of the straight pipe.

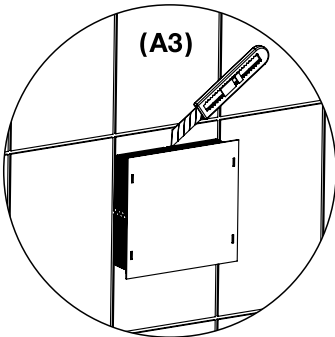

Screw the plastic frame slightly by using screwed bar and keep the springs (B1) that hold the control panel down.

Note: The thickness of the wall should be minimum 15 mm.

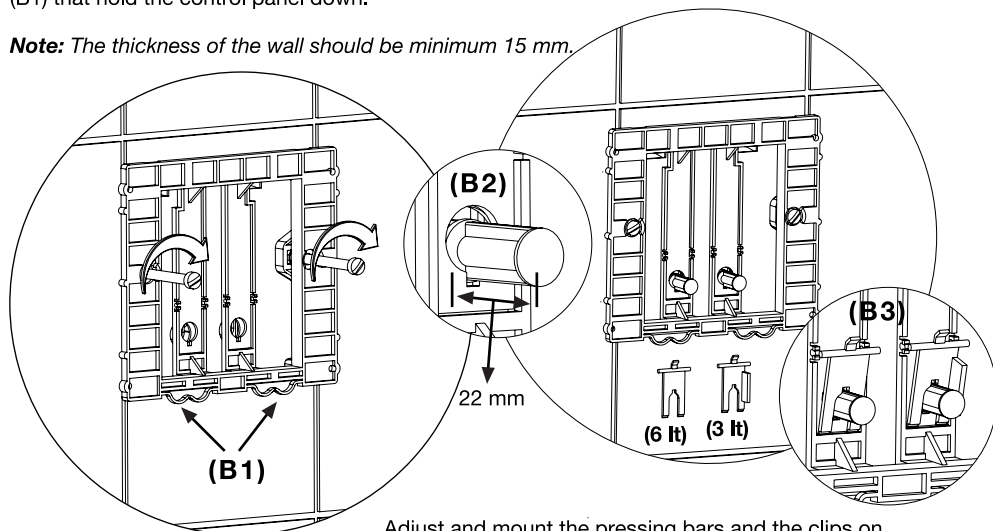

Adjust and mount the pressing bars and the clips on the moving arm as in figure B2 and then mount the 3 litres clip of the 3-6 litres clips on the right side as in figure B3.

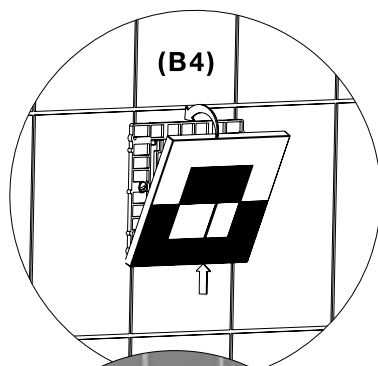

MOUNTING CONTROL PANEL

Place the springs (B1) on the plastic frame to the channel of the down inside of the control panel. Later on, place the upper inside channel of the control panel to the plastic frame (B4) by lifting from bottom to up.

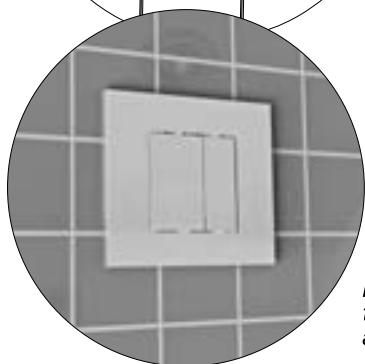

NOTE: The wall plugs that come out of screw set are the concrete wall plugs. Use the suitable wall plug according to the type of wall and floor.

- 1 - Warranty duration is 5 years except gaskets and the duration begins after delivering the material.
- 2 - All the parts of the material are under guaranteed by our company.
- 3 - In case of malfunction during warranty period, the repairing time would be added to warranty period.
The repairing period is maximum 30 business days. This period of time begins when the malfunction get notified to the service station and if there is none, it begins when seller of the material, agent, representative, importer or producer get notified. In case of the defect of the industrial material is not fixed in 15 business days, the producer must provide the similar industrial material to the consumer until the defect is fixed.
- 4 - During the time of the warranty, if there is a defection in the material because of the production, the cost of the labor, the cost of the changed parts or any fee will not be paid by the buyer while repairing.
- 5 - The material, in a year from the day delivered, in the condition of staying in the period of warranty, the repetition of same failure twice or different failures more than four times or because of these failures, if the material's not being able to use permanently and exceeding the maximum time of repairing, in the situation of service station's is not being exist, the seller, the agent, the representative, the importer or producer could prepare a report that mentions that the defect cannot be repaired so that the consumer either could exchange the defected material without any payment or could ask a fully refund or could ask a discount for the percentage of the defect. The above mentioned report must be prepared in 7 days after the consumer's application. In case of the report could not be prepared in 7 days or the report is rejected by the consumer, the consumer could apply Arbitration Court to determine existing situation. The seller cannot reject the consumer's demands that declared in the public act. The seller, the agent, the representative, the importer and the producer are responsible severally against the consumer's demands.
- 6 - The malfunctions that caused by wrong installation and misusing against the installation guide and the operating manual are out of warranty.
- 7 - It can be applied to the Ministry of Industry and Commerce and the Directorate General of Protection of the Consumer and Competition if there will be a problem with warranty certificate.

USAGE MISTAKES

- The filter should be used in the installations.
- The installation guide should be viewed before the installation.
- The installation should be done by the recommended plumbers from the authorized dealer.
- The installation should be done as in the installation guide.
- The clean and waste water plugs that come with the product should be kept the material until the face mold installed.
- The installation axis and the WC pan's dimensions should be compatible to each other.