

Warranty Information *

Proof of purchase will be required.

The guarantee does not cover faults or damage caused by incorrect installation and/or maintenance, ordinary wear and tear, water composition, etc.

*Please see www.deva-uk for full terms and conditions of warranty

Cleaning

Your product has a high-quality finish and should be treated with care to preserve the visible surfaces. Never use abrasives or abrasive cleaning agents to clean this product clean regularly with contamination free warm water and a damp soft cloth. Do not use products containing chlorine bleach or hydrochloric acid as these can damage the product.

We have a policy of continuous improvement and reserve the right to change specifications without notice.

METHVEN UK LIMITED
METHVEN EXPERIENCE CENTRE
3/3A STONE CROSS COURT
YEW TREE WAY
GOLBORNE
WARRINGTON
WA3 3JD
UNITED KINGDOM
INST-SPE01, SPE01/G & SPE03
22.06.2022

TEL: 0800 195 1602
FAX: 0844 406 8690
EMAIL: sales@uk.methven.com
www.deva-uk.com
www.methven.com

Round Wall Union

SPE01, SPE01/G & SPE03

Installation Guide

Technical Specification

Inlet Connections:

1/2" BSP

Features:

- Brass Construction
- 40mm Thread Length



METHVEN
www.methven.com EST 1886

Congratulations on your purchase of your new Methven Round Wall Union.
Our fitting instructions have been created with you in mind to provide you with all the information you require and, if you need any further help, please don't hesitate to contact our customer care team on 0800 195 1602.

Please keep these instructions for future reference and request of replacement parts

General Safety Information

Please read all of the instructions before installation.
Methven recommends this product is installed by a competent person in compliance with all relevant regional regulations.
Remove all packaging and check the components for damage before starting installation.
This product must not be modified in any way as this will invalidate the guarantee.
It is the responsibility of the installer to ensure a waterproof seal is achieved, after installation all connections must be checked for leaks.
All outlets used primarily for personal hygiene shall deliver water at a safe temperature as per regional regulations.

Installation Requirements

Before commencing installation of the new product, ensure that the system has been flushed to remove any debris, which could cause damage to the valves and invalidate the warranty.

Line Drawing

SPE01 & SPE01/G

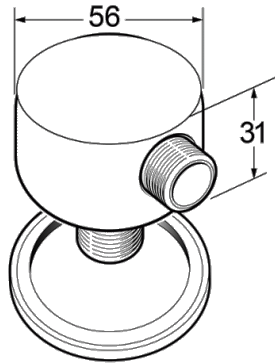

SPE03

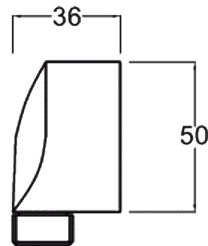
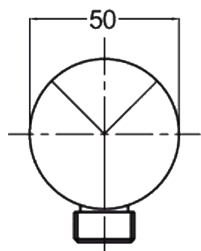

Installation

- The pipe connecting the shower hose connector to the shower and the hole for the wall elbow tail to fit through should be prepared in the desired location.
- If using copper pipe, the pipe end should not be cut until the elbow has been received, so that the correct length pipe can be determined.
To do this place the elbow to the wall, with the wall trim (Not included with SPE03) (if this is to be used dependent on wall thickness) fitted between the elbow and the wall, then cut pipe to correct length, if compression fitting ensure that the pipe length allows for a minimum of 10mm pipe to be inserted into the tail.
- If copper pipes are used, these should be bracketed.
- If plastic pipes or flexi-tails are being used, then the back nut must be fitted to hold the elbow into position.
- Remove the elbow from the wall then fit trim (if applicable) (Not included in SPE03)
- Place the tail through the hole in the wall and screw on the back nut until secure, then connect a pipe nut (not supplied) with sealing method dependent on installers method of connection and tighten until water tight.
- When fully tightened, turn on water supply and check for leaks.
Connect the shower hose to the outlet.

THIS PRODUCT MUST BE USED IN SUCH A WAY AS TO ENSURE ANY WATER FLOW IS DIRECTED TOWARD A SUITABLE LOCATION AND CANNOT CAUSE WATER DAMAGE.

