

Technical Data Sheet

Sign Wall Mounted Spout - T171402

ROPER RHODES®

No.	Description	Code	Fixings Included
1	Sign Wall Mounted Spout	T171402	YES



Min Pressure:	0.3bar
0.2bar	9 litres / min
0.3bar	10.9 litres / min
0.4bar	12.4 litres / min
0.5bar	13.8 litres / min
1bar	19.7 litres / min
2bar	27.3 litres / min

Dimensions - T171402

Diagrams not to scale. All dimensions in mm (tolerance of +/-5mm)

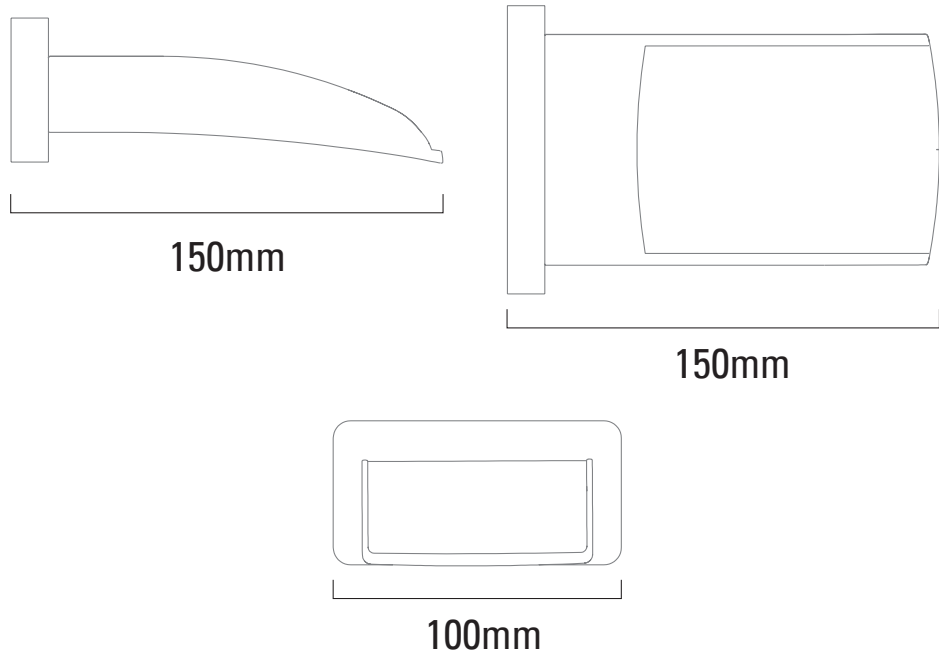

*Dimensions are subject to change, customers are advised to measure actual product before commencing installation.

FAQs

- What is the size of the spout connection?** The spout has a standard 1/2" thread.
- What is the size of the back plate?** 100mm (w) x 50mm (h)
- What is the length of the connector thread?** 18mm

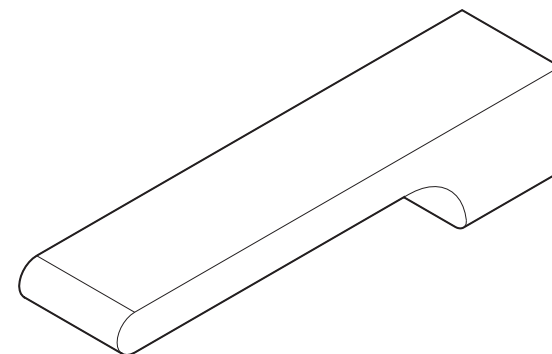

Product code
T171402 / T181402 / T191402 / T201402

ROPER RHODES

Customer Service
Tel: 01225 303 900 Fax: 01225 448 877
Email: sales@roperrhodes.co.uk
www.roperrhodes.co.uk

Roper Rhodes Limited
Brassmill Lane Trading Estate, Bath, BA1 3JF

Wall Spout Sign/Image/Code/Sync

Installation & aftercare instructions

Please retain for future reference

Code Model Shown for Illustration purposes

Installation Procedure:

Before installation commences ensure that the water supply is turned off.

1. The wall connector is supplied inside the wall spout . Note and mark the point that the wall connector protrudes from the wall spout body (and back plate if included). Remove the grub screws from the base of the spout body and carefully remove the wall connector. Some models have an extra washer that should be removed alongside the wall connector.

2. Plumb the wall connector into the concealed water supply using PTFE tape. The point on the wall connector marked in Step 1 should be positioned flush with the outside edge of the wall tiles / surface. Ensure that the two rubber washers are still attached to the opposite end of the wall connector as these form a water-tight seal inside the spout body.

3. Once the plumbing connections are made the spout body (plus back plate if provided) and any washers removed earlier can be pushed onto the wall connector and secured in place by re-inserting the grubs screws into the spout body and tightening with a hex key.

4. When secure, the aerator can be removed using the supplied key and water flushed through the system to remove any dirt or debris from the system. After running water through the system for five minutes the aerator can be screwed back into place. It is advised that the aerator and system are periodically cleaned in this manner to prevent damage to the system throughout its use.

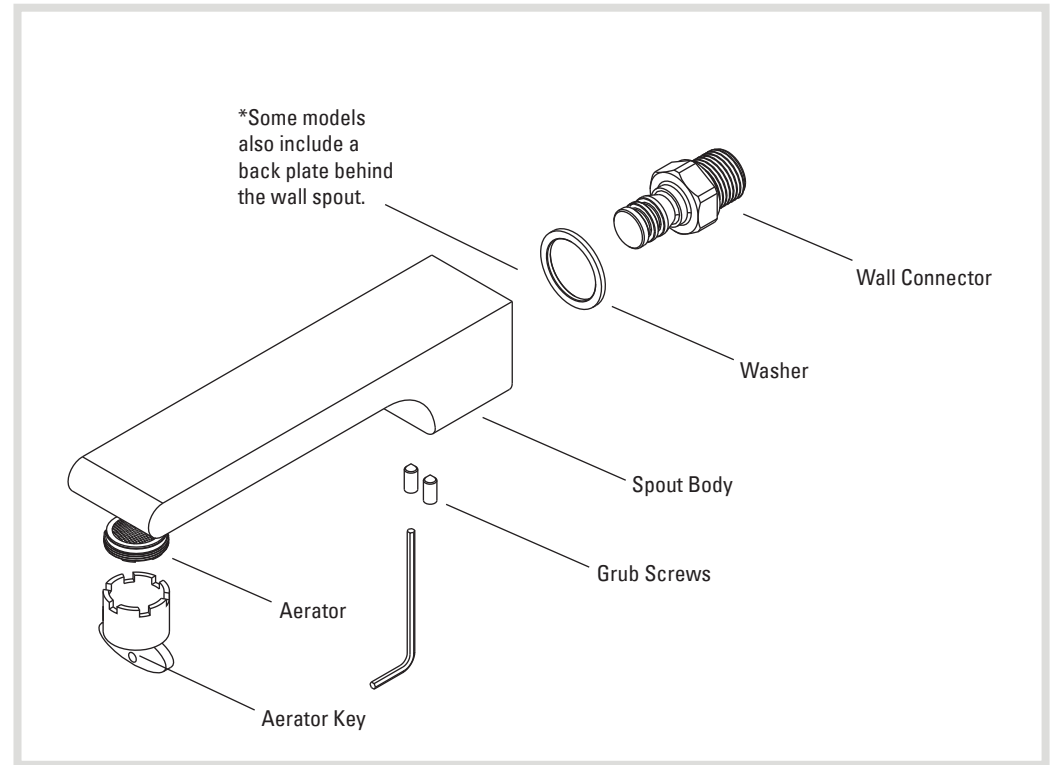

Aftercare Instructions

Whilst this item has a high quality durable finish, it should nevertheless be treated with care. Surfaces should be cleaned using only a soft damp cloth and clean water & dried using a soft cotton cloth. Bath cleaning products, even non-scratch ones could damage the finished surface.

10 Year Guarantee

We have complete confidence in this Roper Rhodes product and as such it is offered with a 10-year guarantee against defects in manufacture. The guarantee requires that this product be used in the manner for which it was intended and that it is installed & maintained in accordance with the fitting instructions and local water bylaws. The guarantee covers products in domestic use only. The guarantee is invalidated should the mixer be damaged by water borne debris. Make sure that supply pipes are clear of any debris prior to installation, this is particularly important on new plumbing installations. In the unlikely event that this product should fail during the guarantee period we will either replace the faulty part or the complete unit as appropriate.