

Sales Code: CBI131

Description: 800 Wall Hung 2-Drawer Unit & Basin

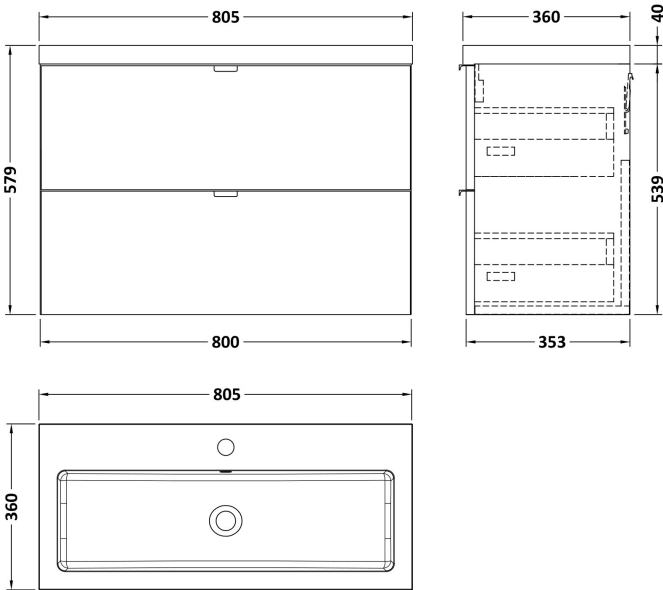

Packaging Details

Barcode: 5056211815457

Sales Code: OFF139

Description: 800 2-Drawer Wall Hung Unit

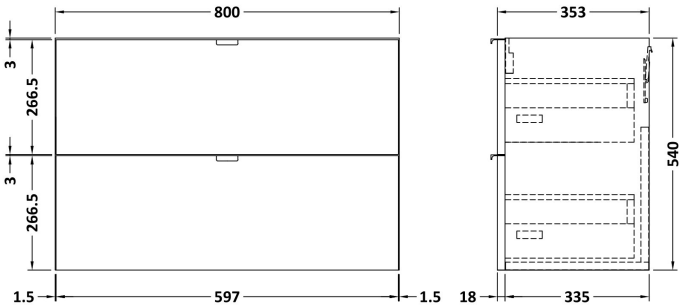

Product Dimensions	
Height (mm):	540
Width (mm):	800
Depth (mm):	353
Nett Weight (kg):	25.5
Packaging Dimensions	
Height (mm):	375
Width (mm):	820
Depth (mm):	560
Gross Weight (kg):	26
Packaging Data	
Box Colour:	Brown Cardboard Box
Box Qty:	1
Label Size:	x
Label Colour:	White Label
Label Qty:	0
Outer Box Dimensions (If Applicable)	
Height (mm):	
Width (mm):	
Depth (mm):	
Gross Weight (kg):	
Barcode:	5056211813002
Product Details	
Country of Origin:	China
Fitting Instruction:	No
CE & UKCA:	N/A
FSC Certified Materials:	Yes
Colour:	Gloss White
Construction Method:	Cam & Wood Dowel
Construction Type:	Rigid
Cabinet Finish:	MFC Painted Gloss
Fascia Finish:	MFC Painted Gloss
Cabinet Thickness (mm):	16
Fascia Thickness (mm):	18
Drawer Included:	Yes
Drawer Type:	80mm High Metal Softclose
No of Shelves:	0
Hinge Type:	Not Applicable
Hinge Included:	Not Applicable
Adjustable Legs:	No, Not Required
Fixings Included:	Yes
Handle Style:	Modern
Waste Shroud:	Yes
Handle Included:	Yes, Supplied
Handle Type:	Wrapover

Sales Code: PMB315

Description: 800 Rear Tap Basin 1Th

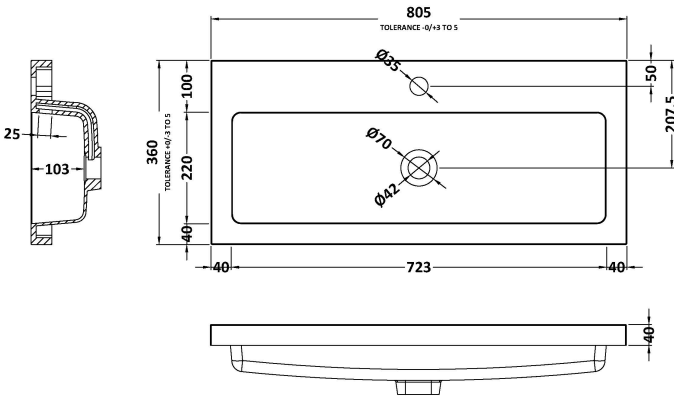

Product Dimensions

Height (mm):	355
Width (mm):	803
Depth (mm):	135
Nett Weight (kg):	12

Packaging Dimensions

Height (mm):	200
Width (mm):	420
Depth (mm):	855
Gross Weight (kg):	12

Packaging Data

Box Colour:	Brown Cardboard Box - Printed
Box Qty:	1
Label Size:	100 x 50
Label Colour:	White Label
Label Qty:	2

Outer Box Dimensions (If Applicable)

Height (mm):	
Width (mm):	
Depth (mm):	
Gross Weight (kg):	
Barcode:	5055275828113

Product Details

Country of Origin:	China
Fitting Instruction:	No
Certification: CE & UKCA:	No
WRAS:	N/A
WRAS No:	N/A
Product Material:	Polymarble
Fixing Supplied:	No

Pans/Bidets:	Trap Style: Not Applicable	Includes Seat: Not Applicable
---------------------	----------------------------	-------------------------------

Seats:	Seat Type: Not Applicable	Material: Not Applicable
	Function: Not Applicable	Hinge Type: Not Applicable
	Hinge Material: Not Applicable	

Cisterns:	Operating Type: Not Applicable	Fittings: Not Applicable
	Lever Type: Not Applicable	

Basins:	Tap Hole: One Taphole	Chain Stay Hole: No
	Template: Not Required	Waste Type Req: Slotted
	Overflow Inc: Yes	Overflow Cover: Yes
	Inner Bowl Depth (mm):	103mm

Sales Code: CBM315

Description: Ceramic Rear Tap Basin 805X360

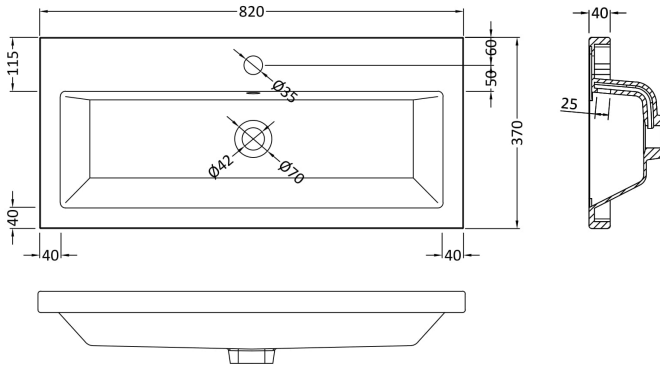

Product Dimensions		
Height (mm):	150	
Width (mm):	805	
Depth (mm):	360	
Nett Weight (kg):	12	
Packaging Dimensions		
Height (mm):	855	
Width (mm):	420	
Depth (mm):	200	
Gross Weight (kg):	12	
Packaging Data		
Box Colour:	Brown Cardboard Box - Printed	
Box Qty:	1	
Label Size:	100 x 50	
Label Colour:	White Label	
Label Qty:	2	
Outer Box Dimensions (If Applicable)		
Height (mm):		
Width (mm):		
Depth (mm):		
Gross Weight (kg):		
Barcode:	5056211875796	
Product Details		
Country of Origin:	China	
Fitting Instruction:	No	
Certification: CE & UKCA: No	WRAS: N/A	WRAS No: N/A
Product Material:	Vitreous China	
Fixing Supplied:	No	
Pans/Bidets:		
Trap Style:	Not Applicable	Includes Seat: Not Applicable
Seats:		
Seat Type:	Not Applicable	Material: Not Applicable
Function:	Not Applicable	Hinge Type: Not Applicable
Hinge Material:	Not Applicable	
Cisterns:		
Operating Type:	Not Applicable	Fittings: Not Applicable
Lever Type:	Not Applicable	
Basins:		
Tap Hole:	One Taphole	Chain Stay Hole: No
Template:	Not Required	Waste Type Req: Slotted
Overflow Inc:	Yes	Overflow Cover: Yes
Inner Bowl Depth (mm): 103mm		