

PRODUCT DATA SHEET



PRODUCT CODE
PRO1510LBPC

RANGE
MPRO

DESCRIPTION
MPRO 2 Handle Trimset (must be paired with WLBP1500RC+) Chrome

WEBSITE LINK [Click Here](#)



| | |
|-----------------------|---------------|
| CATEGORY | Brassware |
| WARRANTY DETAILS | 15 Years |
| COLOUR | Chrome |
| FINISH APPLICATION | Electroplated |
| PRIMARY MATERIAL | Brass |
| INSTALL TYPE | Wall Mounted |
| PRODUCT WIDTH MM | 120 |
| PRODUCT HEIGHT MM | 215 |
| PRODUCT NET WEIGHT KG | 1.4 |

| | |
|------------------------------------|----|
| SWIVEL SPOUT | No |
| WASTE INCLUDED | No |
| ANTI-SCALD | No |
| ENERGY SAVING | No |
| SHOWER HOSE & HANDSET ARE INCLUDED | No |

| | | | | | | | |
|---------------------|-----|-----|---|---|---|---|---|
| PRESSURE (BAR) | 0.2 | 0.5 | 1 | 2 | 3 | 4 | 5 |
| PRIMARY FLOWRATE | | | | | | | |
| HANDSET FLOWRATE | | | | | | | |
| MASSAGE FLOW RATE | | | | | | | |
| AIR FLOW RATE | | | | | | | |
| WIRE FLOW RATE | | | | | | | |
| WATERFALL FLOW RATE | | | | | | | |
| MIST FLOW RATE | | | | | | | |
| HANDSPRAY FLOW RATE | | | | | | | |

TECHNICAL DIMENSIONS

Dimensions in mm unless otherwise specified.

Tolerances (per material type) apply.

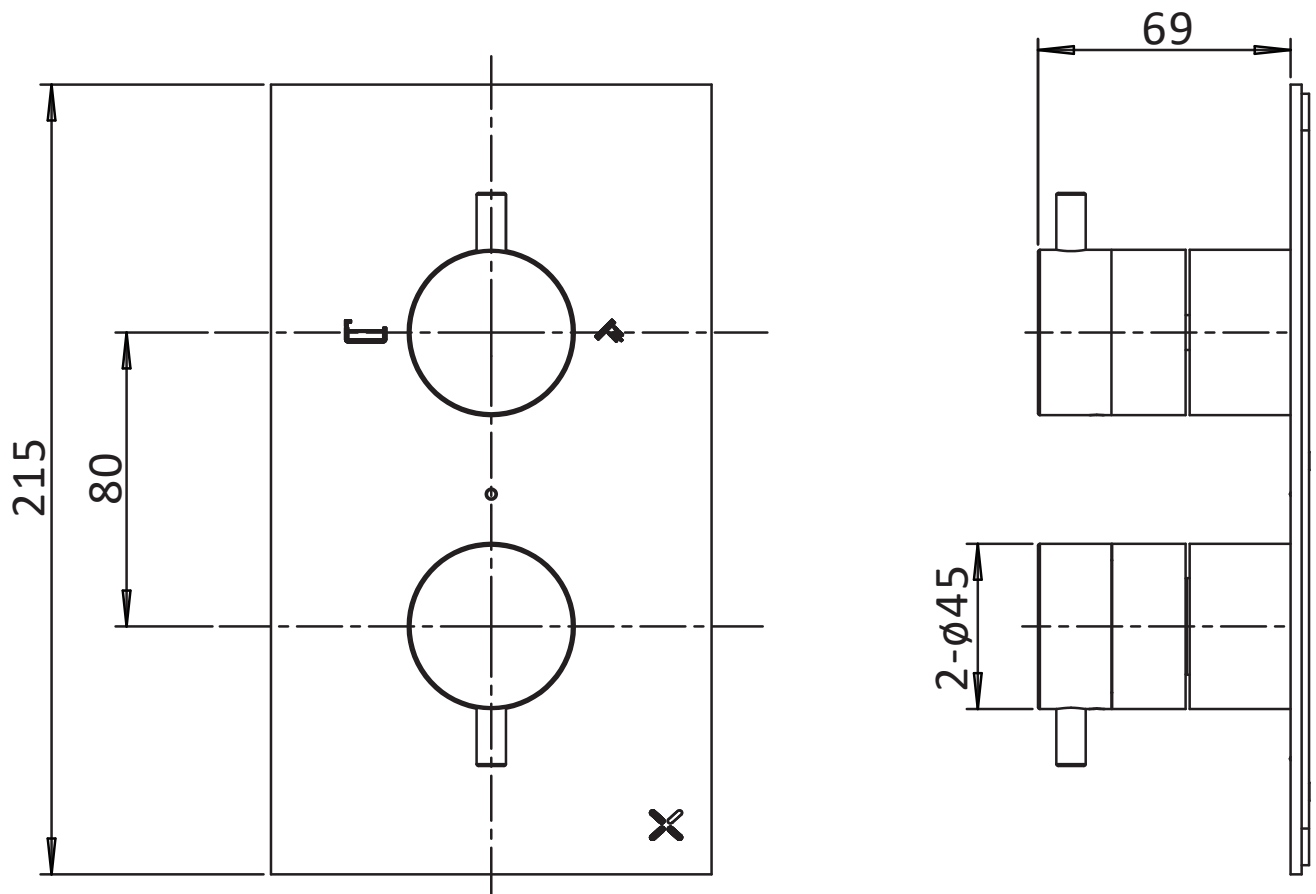

PRODUCT DATA SHEET



PRODUCT CODE
WLBP1500R

RANGE
Thermo SV

DESCRIPTION
2 Way Diverter Valve Body With No Collars

WEBSITE LINK [Click Here](#)

| | |
|----------------------------|--------------|
| CATEGORY | Brassware |
| WARRANTY DETAILS | 15 Years |
| PRIMARY MATERIAL | Brass |
| INSTALL TYPE | Wall Mounted |
| PRODUCT WIDTH MM | 66 |
| PRODUCT HEIGHT MM | 184 |
| PRODUCT DEPTH MM | 132 |
| PRODUCT NET WEIGHT KG | 2.5 |
| MINIMUM PRESSURE (BAR) | 0.5 |
| MAX WORKING PRESSURE (BAR) | 5 |

| | |
|------------------------------------|-------------------------------------|
| STANDARDS | BS EN 1111:2017 |
| NUMBER OF OUTLETS | 2 |
| NUMBER OF FUNCTIONS | 2 |
| HEADWORK | Diverter and Thermostatic Cartridge |
| SWIVEL SPOUT | No |
| INLET CONNECTIONS THREAD | G3/4" |
| OUTLET CONNECTIONS THREAD | G3/4" |
| WASTE INCLUDED | No |
| ANTI-SCALD | No |
| ENERGY SAVING | No |
| SHOWER HOSE & HANDSET ARE INCLUDED | No |

| | | | | | | | |
|---------------------|-----|-------|-------|-------|-------|---|-------|
| PRESSURE (BAR) | 0.2 | 0.5 | 1 | 2 | 3 | 4 | 5 |
| PRIMARY FLOWRATE | | 14.05 | 20.62 | 31.06 | 38.13 | | 50.47 |
| HANDSET FLOWRATE | | | | | | | |
| MASSAGE FLOW RATE | | | | | | | |
| AIR FLOW RATE | | | | | | | |
| WIRE FLOW RATE | | | | | | | |
| WATERFALL FLOW RATE | | | | | | | |
| MIST FLOW RATE | | | | | | | |
| HANDSPRAY FLOW RATE | | | | | | | |

TECHNICAL DIMENSIONS

Dimensions in mm unless otherwise specified.

Tolerances (per material type) apply.

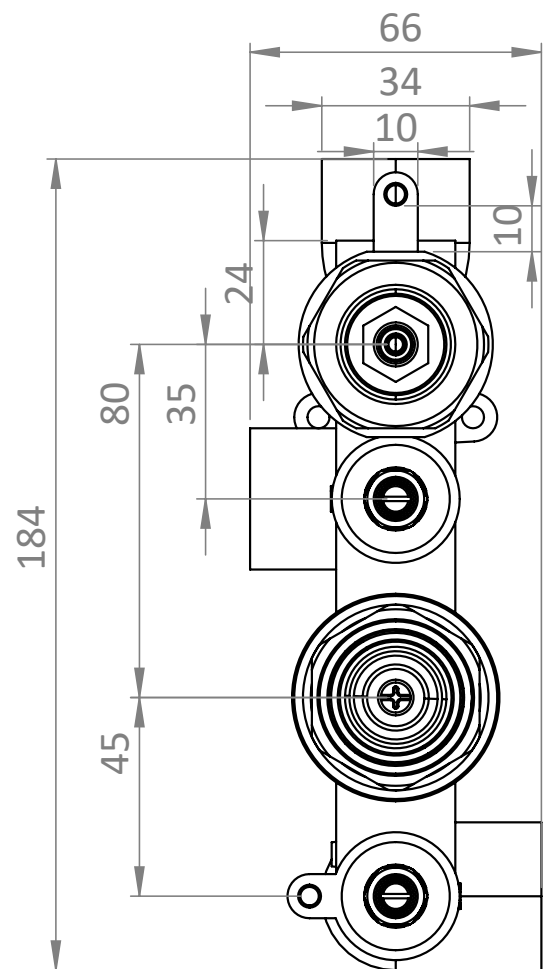
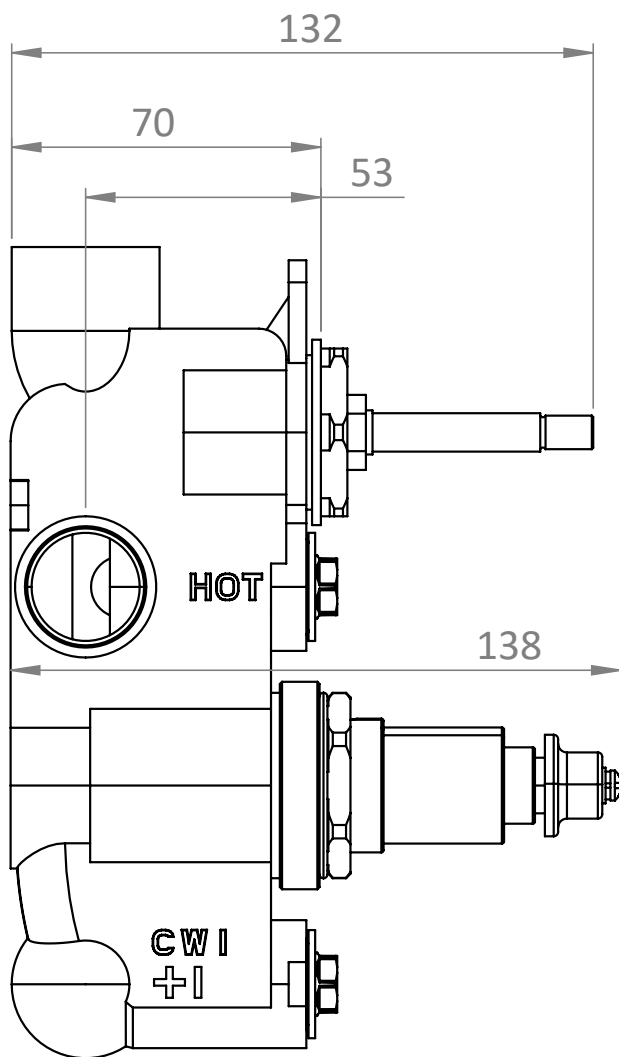

PRODUCT DATA SHEET



PRODUCT CODE
SK971C

RANGE
Shower Kit

DESCRIPTION
Shower Set with Outlet Elbow Chrome

| | |
|----------------------------|---------------|
| CATEGORY | Brassware |
| WARRANTY DETAILS | 15 Years |
| COLOUR | Chrome |
| FINISH APPLICATION | Electroplated |
| PRIMARY MATERIAL | Brass |
| SECONDARY MATERIAL | ABS |
| INSTALL TYPE | Wall Mounted |
| PRODUCT WIDTH MM | 111 |
| PRODUCT HEIGHT MM | 698 |
| PRODUCT DEPTH MM | 45 |
| PRODUCT NET WEIGHT KG | 1.64 |
| MINIMUM PRESSURE (BAR) | 1 |
| MAX WORKING PRESSURE (BAR) | 5 |

| | |
|------------------------------------|----------------|
| APPROVAL | WRAS 240688010 |
| NUMBER OF OUTLETS | 1 |
| NUMBER OF FUNCTIONS | 3 |
| INLET CONNECTIONS THREAD | G1/2" |
| WASTE INCLUDED | No |
| ANTI-SCALD | No |
| ENERGY SAVING | No |
| SHOWER HOSE & HANDSET ARE INCLUDED | Yes |

| | | | | | | | |
|---------------------|-----|-----|-------|-------|-------|-------|-------|
| PRESSURE (BAR) | 0.2 | 0.5 | 1 | 2 | 3 | 4 | 5 |
| PRIMARY FLOWRATE | | | 10.29 | 13.26 | 15.18 | 17.76 | 19.38 |
| HANDSET FLOWRATE | | | | | | | |
| MASSAGE FLOW RATE | | | | | | | |
| AIR FLOW RATE | | | | | | | |
| WIRE FLOW RATE | | | | | | | |
| WATERFALL FLOW RATE | | | | | | | |
| MIST FLOW RATE | | | | | | | |
| HANDSPRAY FLOW RATE | | | | | | | |

TECHNICAL DIMENSIONS

Dimensions in mm unless otherwise specified.

Tolerances (per material type) apply.

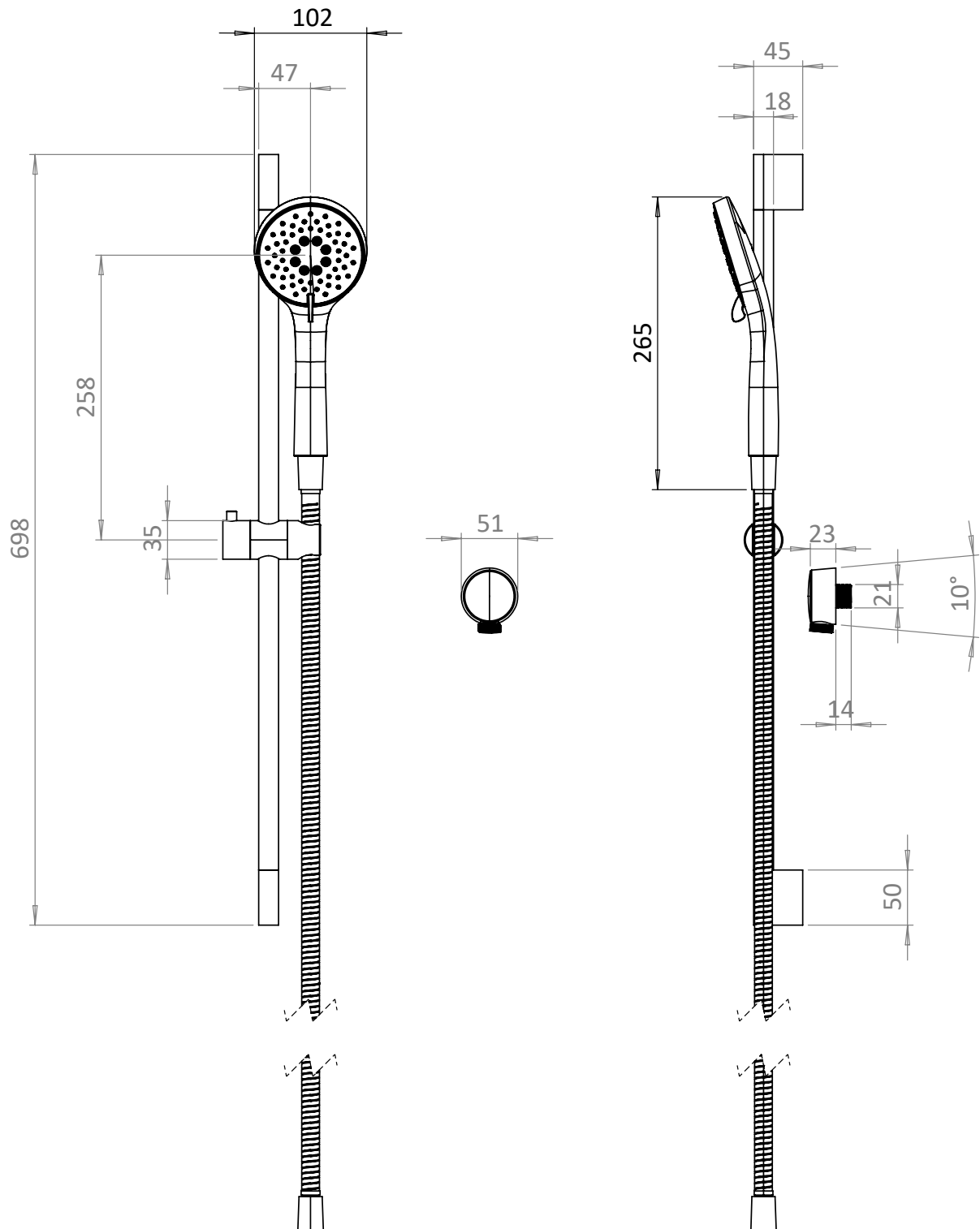

PRODUCT DATA SHEET



PRODUCT CODE
FH620C

RANGE
Shower Arm

DESCRIPTION
Shower Arm 226mm Chrome

| | |
|--------------------|-----------------|
| CATEGORY | Brassware |
| WARRANTY DETAILS | 15 Years |
| COLOUR | Chrome |
| FINISH APPLICATION | Electroplated |
| PRIMARY MATERIAL | Brass |
| INSTALL TYPE | Ceiling Mounted |
| PRODUCT WIDTH MM | 55 |
| PRODUCT HEIGHT MM | 200 |
| PRODUCT DEPTH MM | 55 |

| | |
|------------------------------------|-------|
| NUMBER OF OUTLETS | 1 |
| NUMBER OF FUNCTIONS | 1 |
| INLET CONNECTIONS THREAD | G1/2" |
| OUTLET CONNECTIONS THREAD | G1/2" |
| WASTE INCLUDED | No |
| ANTI-SCALD | No |
| ENERGY SAVING | No |
| SHOWER HOSE & HANDSET ARE INCLUDED | No |

| | | | | | | | |
|---------------------|-----|-----|---|---|---|---|---|
| PRESSURE (BAR) | 0.2 | 0.5 | 1 | 2 | 3 | 4 | 5 |
| PRIMARY FLOWRATE | | | | | | | |
| HANDSET FLOWRATE | | | | | | | |
| MASSAGE FLOW RATE | | | | | | | |
| AIR FLOW RATE | | | | | | | |
| WIRE FLOW RATE | | | | | | | |
| WATERFALL FLOW RATE | | | | | | | |
| MIST FLOW RATE | | | | | | | |
| HANDSPRAY FLOW RATE | | | | | | | |

TECHNICAL DIMENSIONS

Dimensions in mm unless otherwise specified.

Tolerances (per material type) apply.

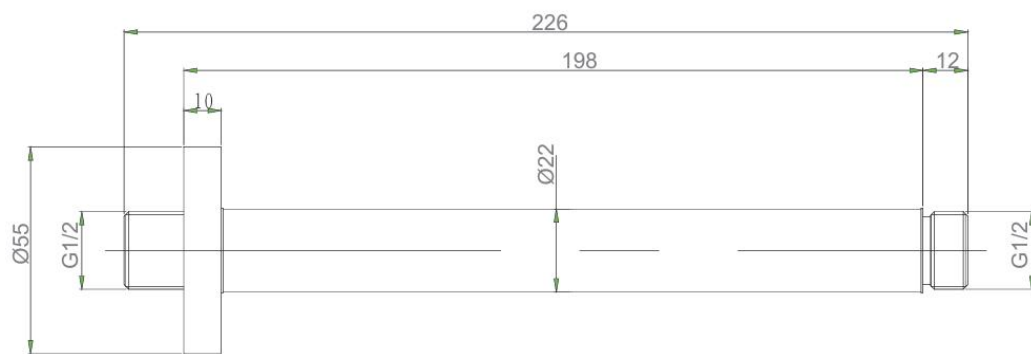

PRODUCT DATA SHEET



PRODUCT CODE
PRO200C_V2

RANGE
MPRO

DESCRIPTION
MPRO 200mm Fixed Head Chrome

WEBSITE LINK [Click Here](#)

| | |
|----------------------------|-----------------|
| CATEGORY | Brassware |
| WARRANTY DETAILS | 15 Years |
| COLOUR | Chrome |
| FINISH APPLICATION | Electroplated |
| PRIMARY MATERIAL | Brass |
| INSTALL TYPE | Ceiling Mounted |
| PRODUCT WIDTH MM | 200 |
| PRODUCT HEIGHT MM | 58 |
| PRODUCT DEPTH MM | 200 |
| PRODUCT NET WEIGHT KG | 0.9 |
| MINIMUM PRESSURE (BAR) | 0.5 |
| MAX WORKING PRESSURE (BAR) | 5 |

| | |
|------------------------------------|--------------|
| APPROVAL | WRAS 1909388 |
| NUMBER OF OUTLETS | 1 |
| NUMBER OF FUNCTIONS | 1 |
| INLET CONNECTIONS THREAD | G1/2" |
| WASTE INCLUDED | No |
| ANTI-SCALD | No |
| ENERGY SAVING | No |
| SHOWER HOSE & HANDSET ARE INCLUDED | No |

| | | | | | | | |
|---------------------|-----|-------|-------|-------|-------|-------|-------|
| PRESSURE (BAR) | 0.2 | 0.5 | 1 | 2 | 3 | 4 | 5 |
| PRIMARY FLOWRATE | | 12.75 | 16.48 | 23.31 | 26.58 | 31.36 | 35.39 |
| HANDSET FLOWRATE | | | | | | | |
| MASSAGE FLOW RATE | | | | | | | |
| AIR FLOW RATE | | | | | | | |
| WIRE FLOW RATE | | | | | | | |
| WATERFALL FLOW RATE | | | | | | | |
| MIST FLOW RATE | | | | | | | |
| HANDSPRAY FLOW RATE | | | | | | | |

TECHNICAL DIMENSIONS

Dimensions in mm unless otherwise specified.

Tolerances (per material type) apply.

