

Sales Code: ENZW089

Barcode: 5056678427996

Brand: nuie

Description: nuie 700mm Framed Walk-In Wetroom Return Screen With Chrome Tray

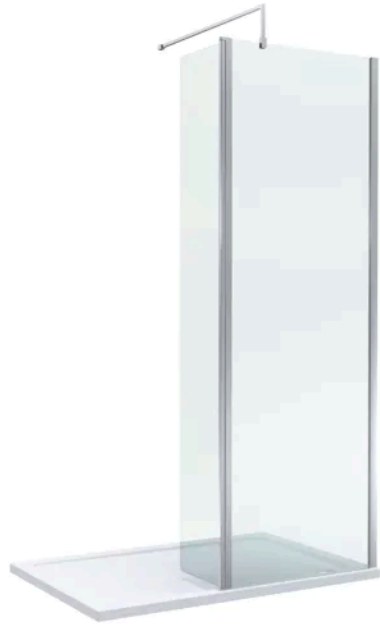

Technical Drawing Not Available

Product Dimensions

| | |
|-----------------|-------------------------------|
| Product | 1950 x 700 x 40mm (H x W x D) |
| Nett Weight | 71.01 kg |
| Packaged Weight | 71.04 kg |

Product Details

| | |
|-------------------|---|
| Country of Origin | China |
| Product Material | Acrylic Capped Abs Caco3 And Pu,Aluminium,Glass |
| Colour/Finish | Chrome |
| Style | Contemporary |
| Ce Certified | Yes |
| Enclosure Design | Framed |
| Glass Thickness | 8 mm |
| Waste Included | No |

Sales Code:
WRSB700G

Barcode: 5056462620718

Brand: Hudson
Reed

Description: Wetroom Screen 700 X1950mm

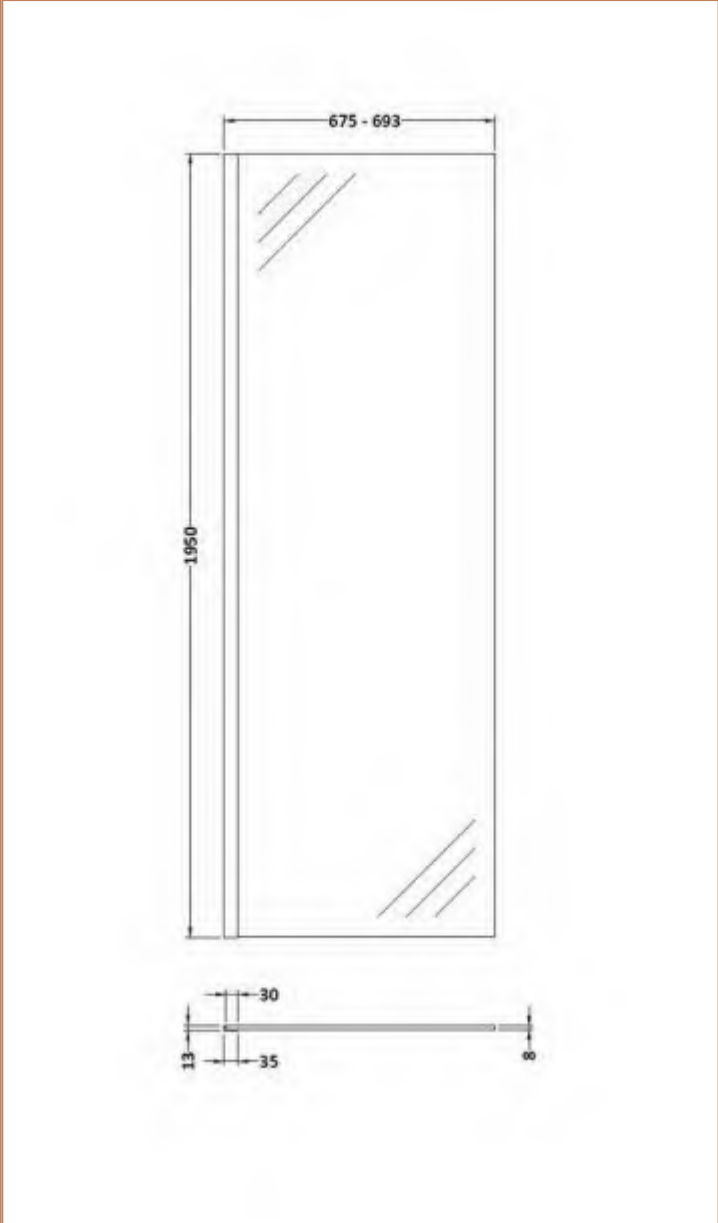
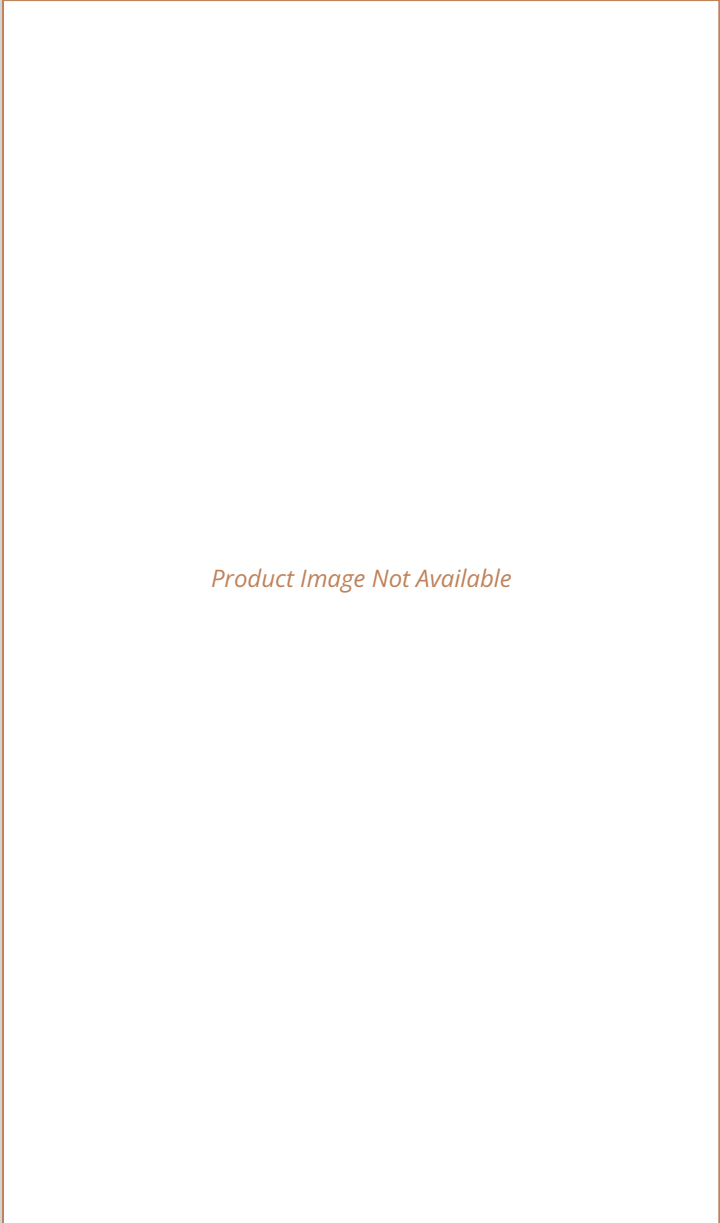

| Product Dimensions | |
|----------------------------|-------------------------------|
| Product | 1950 x 700 x 40mm (H x W x D) |
| Packaged | 2070 x 750 x 60mm (H x W x D) |
| Nett Weight | 29.44 kg |
| Packaged Weight | 29.44 kg |
| Packaging Details | |
| Label Size (mm) | 50 x 100 |
| Product Details | |
| Country of Origin | China |
| Product Material | Aluminium |
| Colour/Finish | Chrome |
| Style | Contemporary |
| Easy Clean | Yes |
| Adjustment Max | 693 |
| Adjustment Min | 675 |
| Ce Certified | Yes |
| Declaration Of Performance | Yes |
| Easy Fit | No |
| Enclosure Design | Semi-Frameless |
| Frame Finish | Chrome |
| Glass Thickness | 8 mm |
| Handles Included | No |
| Support Bar Included | No |
| Ukca Certified | Yes |

Sales Code: WRSF018

Barcode: 5056462620695

Brand: Hudson Reed

Description: Hudson Reed Chrome Wetroom Screen

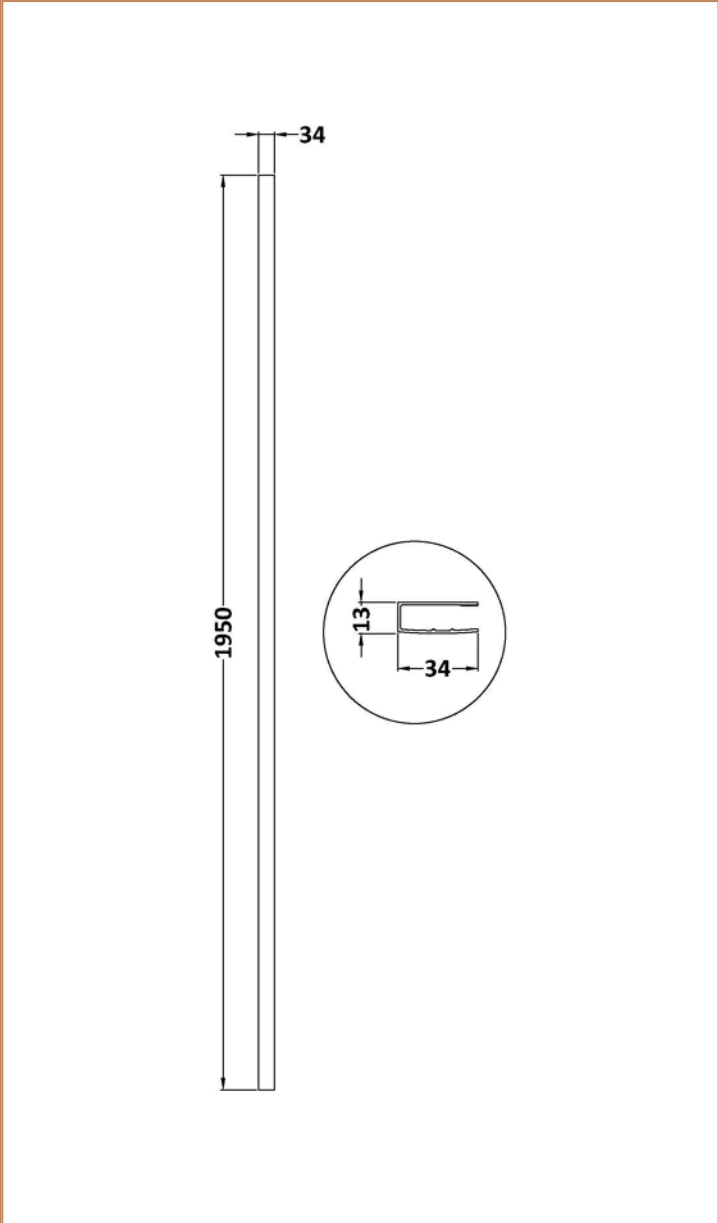

Product Dimensions

| | |
|-----------------|-------------------------------|
| Product | 1950mm (H) |
| Packaged | 45 x 185 x 1970mm (H x W x D) |
| Nett Weight | 0.8 kg |
| Packaged Weight | 0.8 kg |

Product Details

| | |
|-------------------|--------|
| Country of Origin | China |
| Colour/Finish | Chrome |
| Ce Certified | Yes |
| Frame Finish | Chrome |

Sales Code: WRSA030HC

Barcode: 5056678429822

Brand: Hudson Reed

Description: Hudson Reed 300mm Chrome Semi-Frameless Wetroom Panel

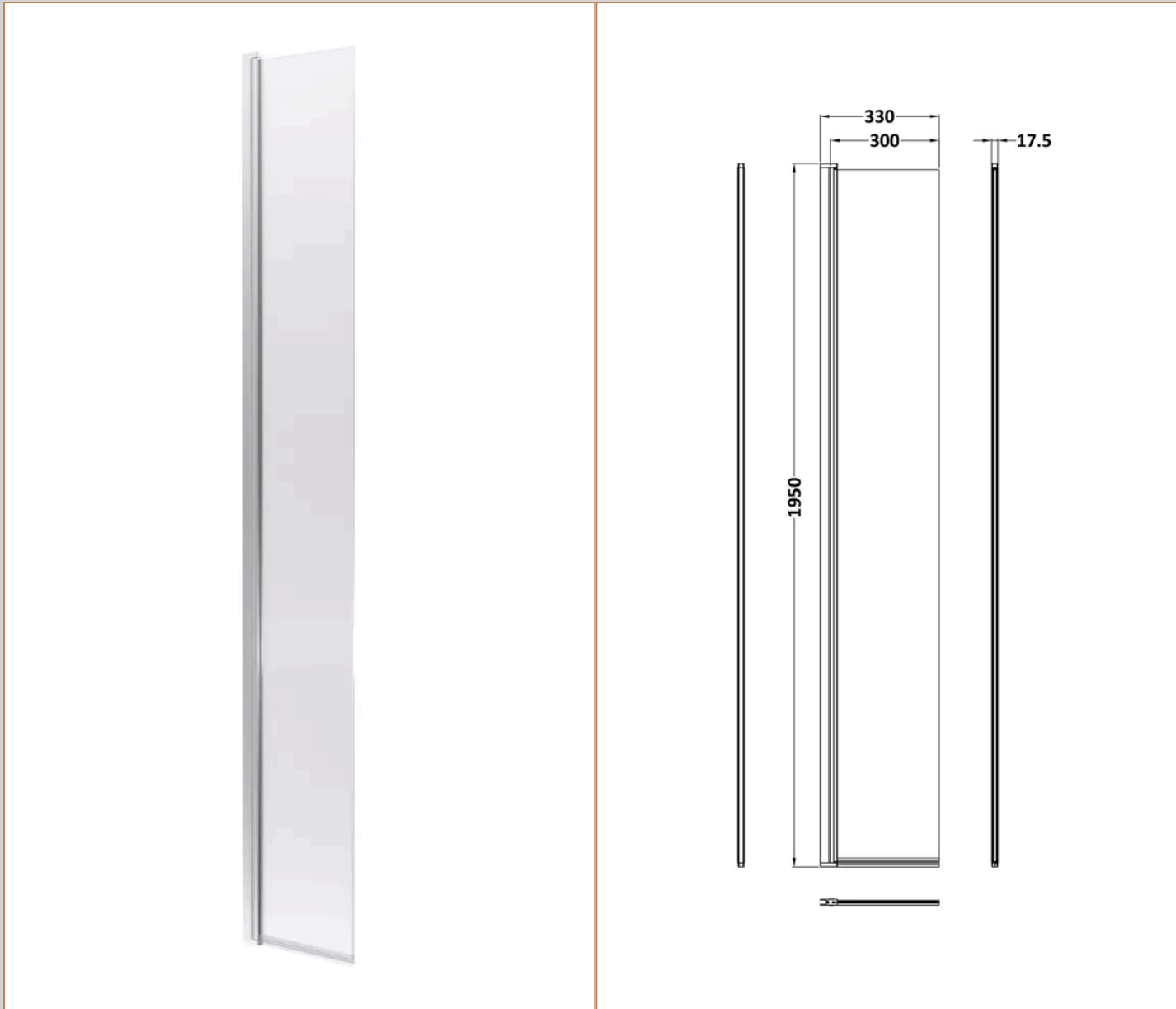

Product Dimensions

| | |
|-----------------|-------------------------------|
| Product | 1950 x 322 x 27mm (H x W x D) |
| Packaged | 55 x 400 x 2000mm (H x W x D) |
| Nett Weight | 15.1 kg |
| Packaged Weight | 15.1 kg |

Packaging Details

| | |
|-----------------|----------|
| Label Size (mm) | 50 x 100 |
| Label Colour | White |
| Label Qty | 2.0000 |

Product Details

| | |
|----------------------------|----------------|
| Country of Origin | China |
| Product Material | Aluminium |
| Colour/Finish | Chrome |
| Style | Contemporary |
| Fixings Included | Yes |
| Easy Clean | Yes |
| Adjustment Max | 300 |
| Adjustment Min | 300 |
| Ce Certified | Yes |
| Declaration Of Performance | No |
| Easy Fit | No |
| Enclosure Design | Semi-Frameless |
| Frame Finish | Chrome |
| Glass Thickness | 8 mm |
| Handles Included | No |
| Support Bar Included | No |
| Ukca Certified | No |

Sales Code: FIX023

Barcode: 5056211800002

Brand: nuie

Description: Chrome Wetroom Screen Support Arm

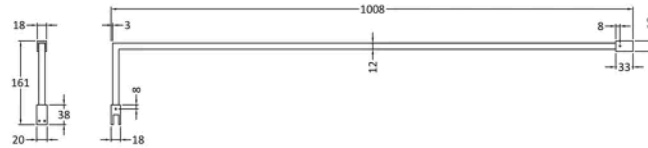

Product Dimensions

| | |
|-----------------|-------------------------------|
| Product | 150 x 15 x 1000mm (H x W x D) |
| Packaged | 1020 x 160 x 35mm (H x W x D) |
| Nett Weight | 0.67 kg |
| Packaged Weight | 0.7 kg |

Product Details

| | |
|-------------------|-----------------|
| Country of Origin | China |
| Product Material | Stainless Steel |
| Colour/Finish | Chrome |
| Style | Contemporary |

Sales Code: NTP023

Barcode: 5055369006311

Brand: nuie

Description: 1200 x 800mm Rectangular Shower Tray

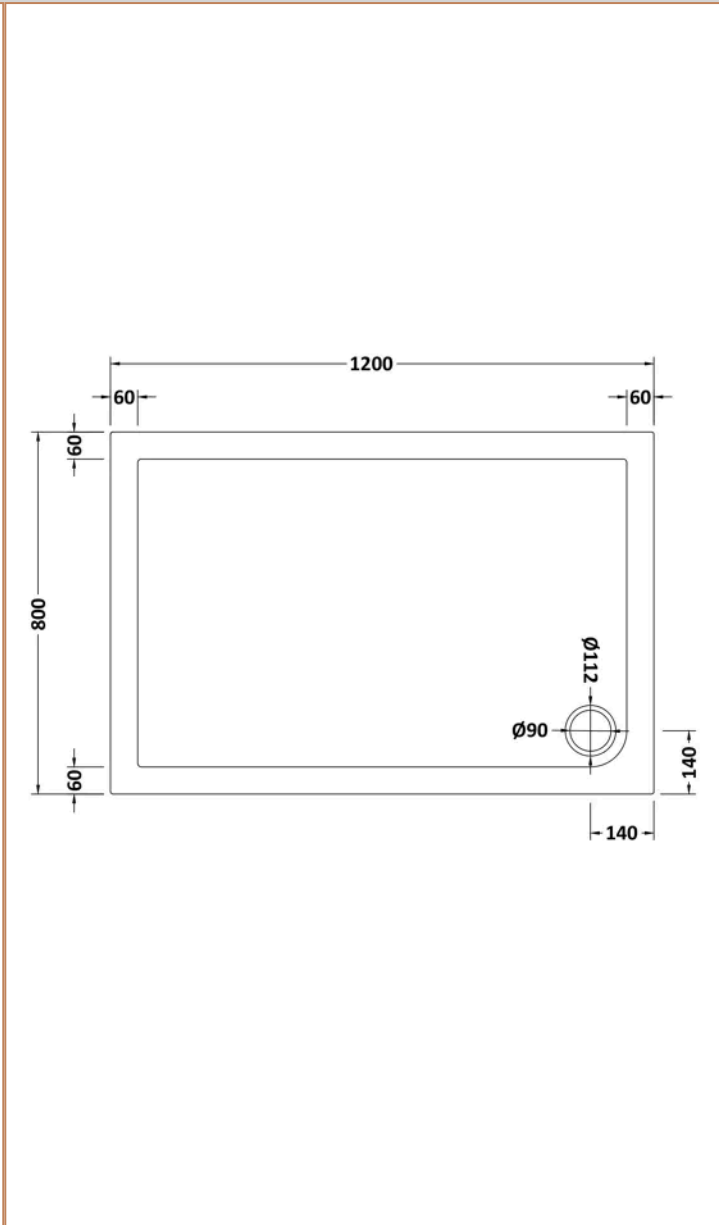

Product Dimensions

| | |
|-----------------|-------------------------------|
| Product | 40 x 800 x 1200mm (H x W x L) |
| Packaged | 80 x 840 x 1240mm (H x W x D) |
| Nett Weight | 29.8 kg |
| Packaged Weight | 30.1 kg |

Product Details

| | |
|---------------------|---------------------------------|
| Country of Origin | United Kingdom |
| Product Material | Acrylic Capped Abs Caco3 And Pu |
| Colour/Finish | White |
| Style | Contemporary |
| Fixings Included | No |
| Ce Certified | Yes |
| Leg Set Included | No |
| Legs Included | No |
| Raised Edge | Yes |
| Slip Resistant | No |
| Waste Included | No |
| Waste Size Required | 90mm |