

Warranty Information

Proof of purchase will be required.

The guarantee does not cover faults or damage caused by incorrect installation and/or maintenance, ordinary wear and tear, water composition, etc.

*Please see www.deva-uk.com for full terms and conditions of warranty

Cleaning

Your product has a high-quality finish and should be treated with care to preserve the visible surfaces. Never use abrasives or abrasive cleaning agents to clean this product clean regularly with contamination free warm water and a damp soft cloth. Do not use products containing chlorine bleach or hydrochloric acid as these can damage the product.

We have a policy of continuous improvement and reserve the right to change specifications without notice.

METHVEN UK LIMITED
METHVEN EXPERIENCE CENTRE
3/3A STONE CROSS COURT
YEW TREE WAY
GOLBORNE
WARRINGTON
WA3 3JD
UNITED KINGDOM

INST-MOS113
V1 20.02.2024

TEL: 0800 195 1602
FAX: 0844 406 8690
EMAIL: sales@uk.methven.com
www.deva-uk.com
www.methven.com

Moselle Basin Mixer & Press Top Waste

Chrome

MOS113

Installation Guide

Technical Specification

Working Pressure:

Min: 0.1 Bar

Max: 5.0 Bar

Operating Temperature:

Hot: 65°C

Cold: 5°C

Inlet Connections:

½" BSP

Features:

- Suitable for high & low pressure systems
- 35mm ceramic cartridge
- H & C temperature indicator
- Tilt and turn temperature and flow control
- Tap Height 149mm,
- Spout Height 97mm
- Spout Reach 110.5mm
- Supplied with fixing kit(metal horseshoe fixing plate, rubber horseshoe fixing washer, metal bar and locking nut)
- Supplied with 2 x M10-450mm flexi tails
- Complete with brass slotted press top waste



Please keep these instructions for future reference and request of replacement parts

Contents

General Safety Information	3
Line Drawing	3
Product Breakdown	4
Product Breakdown	4
Installation Requirements	6
Installation	6
Troubleshooting	7
Warranty Information	8
Cleaning	8

Troubleshooting

Symptom	Cause(s)	Resolution
Mixer not turning on	Mains Water supply turned off	Turn on the mains water supply
	Closed isolation valve	Open isolation valve
No hot water	Cold override	Check if the pressure is balanced. Fit pressure equalising valve.
Low Flow Rate/No Flow	Water supply failure	Investigate water supply, check plumbing and heating system for any faults
	Partially closed isolation valve	Open isolation valve
	Air lock or partial blockage in the supply pipework or hoses	Flush through pipework to ensure removal of debris and any airlocks.
	Water being drawn off elsewhere causing pressure changes or instantaneous boiler temperature changes. Ensure minimum pressure is being met.	Try not to use other water outlets when using the mixer
Water dripping from the mixer	This is normal for a short time after using the mixer	This is due to residual water tension, the build up of water in the mixer spout.
	If water continues to drip, possible issue with the flow control cartridge.	Please contact our customer care team.
Movement of fitted mixer	Fixing kit loose	Ensure fixing kit nut is sufficiently tightened.
	Extra support may be required depending on the surface the tap is fitted to.	Please contact customer care to purchase a under sink mounting triangle

Product Breakdown

Check All components are present prior to starting installation.

Basin Waste

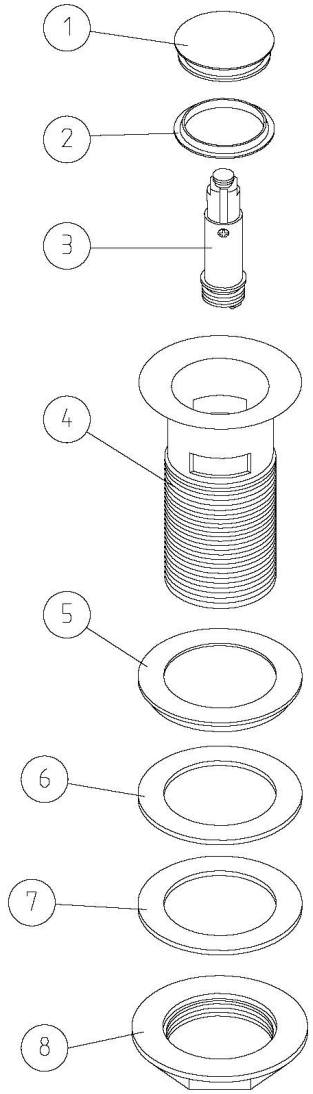

Item Number	Item Description
1	Cover
2	Plug Washer
3	Click Mechanism
4	Waste Body
5	Flange Rubber Washer
6	Rubber Washer
7	White Plastic Washer
8	Backnut

Basin Mixer

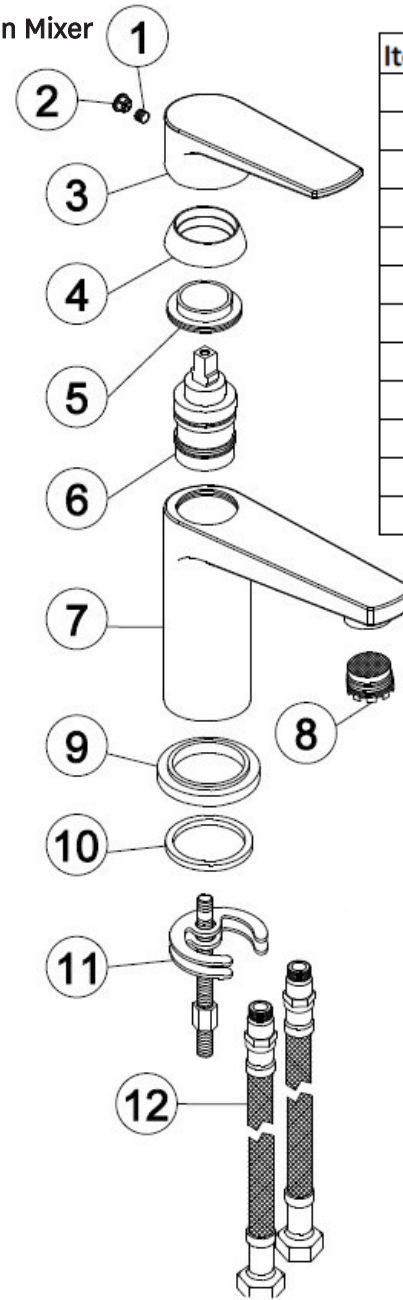

Item Number	Item Description
1	Grub Screw
2	Grub Screw Cap
3	Handle
4	Cartridge Cover
5	Cartridge Locking Nut
6	35mm Ceramic Cartridge
7	Basin Mixer Body
8	Aerator
9	Base Plate
10	Base Plate Washer
11	Fixing Kit
12	Flexi Tails