

# LACE

Kitchen Sink Mixer Tap

LACE171F



 **Devo**<sup>TM</sup> by METHVEN

Installation Guide

# Contents

Congratulations on your purchase of your new Lace Kitchen Sink Mixer. Our fitting instructions have been created with you in mind to provide you with all the information you require and, if you need any further help, please don't hesitate to contact our customer care team on 0800 195 1602

Description	Page
General safety information	3
Features	4
Components list	5
Installation Instructions	6
Troubleshooting	7
Warranty information	8



# General Safety Information

Methven recommends this product is installed by a competent person in compliance with all relevant regional regulations.

Remove all packaging and check the components for damage before starting installation.

This product must not be modified in any way as this will invalidate the guarantee.

It is the responsibility of the installer to ensure a waterproof seal is achieved, after installation all connections must be checked for leaks.

All outlets used primarily for personal hygiene shall deliver water at a safe temperature as per regional regulations.

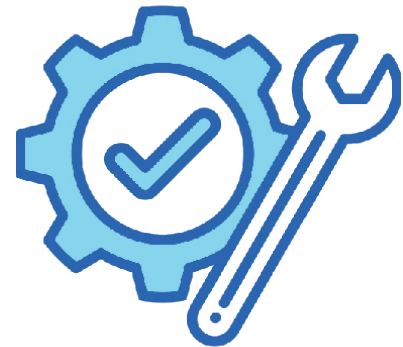

# Lace Kitchen Sink Mixer

Product Code: LACE171F

Finish: Chrome

Construction: Brass

Valve/Cartridge type: 40mm Ceramic cartridge

Supply: Suitable for low pressure plumbing systems

Working Pressures: 0.1 - 5.0 bar

Inlet Connections: 1/2" BSP

Flexi or Copper: Flexi tails

- Swivel spout
- Tilt and turn temperature and flow control
- Easy grip handle with loop

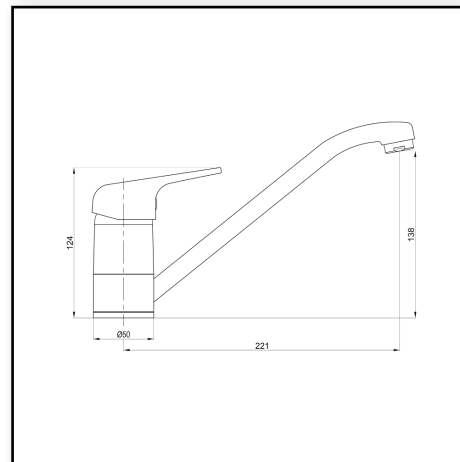

**Deva**™ by METHVEN

# Components List

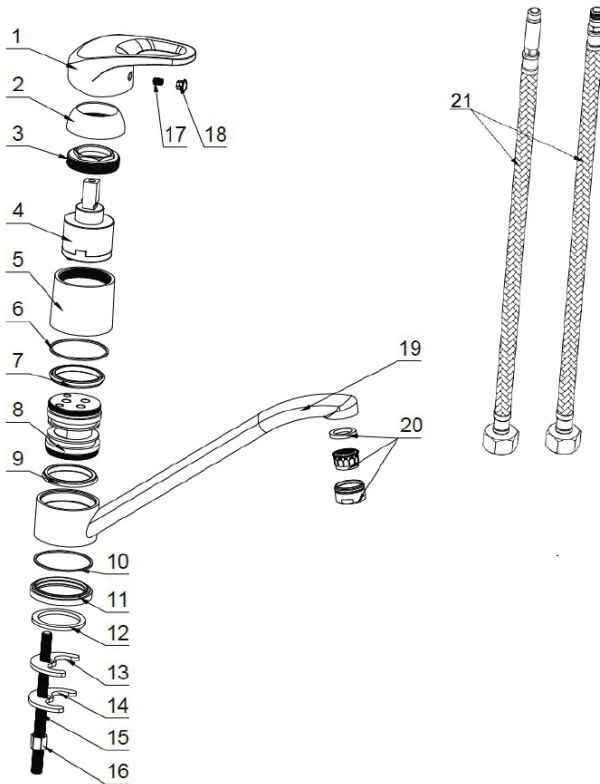

1	Handle
2	Cartridge Cover
3	Cartridge Locking Nut
4	40mm Ceramic Cartridge
5	Joint Sleeve
6	Washer
7	Seal Ring
8	Cartridge Base
9	Seal Ring
10	Washer
11	Base Plate
12	Base Plate Washer
13	Rubber Horseshoe Washer
14	Metal Horseshoe Washer
15	Fixing Kit Threaded Bar
16	Fixing Kit Nut
17	Grub Screw
18	Hot & Cold Indicators
19	Sink Mixer Body
20	Aerator
21	Flexi-tails

# LACE172F

## Installation Instructions

Prior to installation please ensure all supply pipes have been thoroughly flushed through to remove any debris. Isolating valves must be fitted in a convenient position to allow future servicing of the fitting.

1. Screw the threaded fixing bar into the bottom of the mixer body
2. Screw both flexi tails into the tap body, ensuring that the O-Ring on the tail is positioned inside the tap body, this should only need to hand tight. Do not use PTFE tape or similar to create the seal.
3. Offer the tap up to the hole in the sink.
4. On the underside of the sink fit the rubber and metal horseshoe shaped washers onto the threaded fixing bar and using the nut provided tighten until the tap is secure in the mounting hole.

**Note:** Plastic Triangle, If required an under sink mounting triangle can be purchased, this should be used on thin work surfaces to help distribute the weight of the tap and provide a thicker mounting surface for the fixing kit to clamp to.

5. Connect the male end of the tail to the corresponding hot and cold inlets.
6. Reinstate water supply and test for leaks.

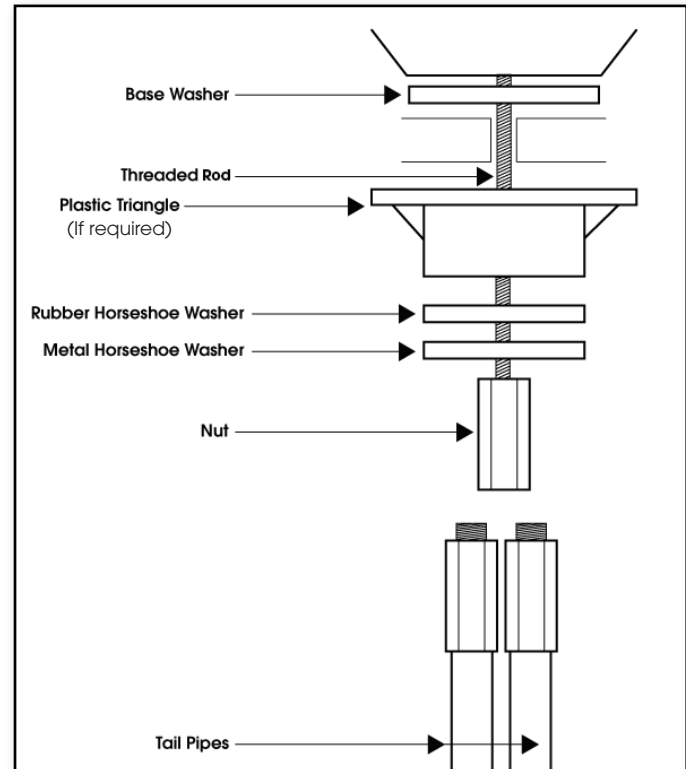

# Troubleshooting Guide

SYMPTOM	CAUSE(S)	RESOLUTION
Mixer not turning on	Mains water supply turned off	Turn on mains water supply
	Closed isolation valve	Open isolation valve
No hot water	Cold override	Check if the pressure is balanced. Fit pressure equalising valve.
Low flow rate/no flow	Water supply failure	Investigate water supply, check plumbing and heating system for any faults
	Partially closed isolation valve	Open isolation valve
	Air lock or partial blockage in the supply pipework or hoses	Flush through pipework to ensure removal of debris and any airlocks
	Water being drawn off elsewhere causing pressure changes or instantaneous boiler temperature changes. Ensure minimum pressure is being met	Try not to use other water outlets when using the mixer
Water dripping from the mixer	This is normal for a short time after using the mixer	This is due to residual water tension, the build up of water in the mixture spout
	If water continues to drip, possible issue with the flow control cartridge	Please contact our customer care team
Movement of fitted mixer	Fixing kit loose	Ensure fixing kit nut is sufficiently tightened
	Extra support may be required depending on the surface the tap is fitted to	Please contact our customer care to purchase an under the sink mounting triangle

# Warranty Information

Proof of purchase will be required. The guarantee does not cover faults or damage caused by incorrect installation and/or maintenance, ordinary wear and tear, water composition, etc.

\*Please see [www.deva-uk.com](http://www.deva-uk.com) for full terms and conditions of warranty

## Cleaning

Your product has a high-quality finish and should be treated with care to preserve the visible surfaces. Never use abrasives or abrasive cleaning agents to clean this product clean regularly with contamination free warm water and a damp soft cloth. Do not use products containing chlorine bleach or hydrochloric acid as these can damage the product.

We have a policy of continuous improvement and reserve the right to change specifications without notice.

METHVEN UK LIMITED  
METHVEN EXPERIENCE CENTRE  
3/3A STONE CROSS COURT  
YEW TREE WAY  
GOLBORNE  
WARRINGTON  
WA3 3JD  
UNITED KINGDOM  
28/11/2025

TEL: 0800 195 1602 FAX: 0844 406 8690

EMAIL: [sales@uk.methven.com](mailto:sales@uk.methven.com)

[www.deva-uk.com](http://www.deva-uk.com)

[www.methven.com](http://www.methven.com)