

PAXTON BASIN MIXER

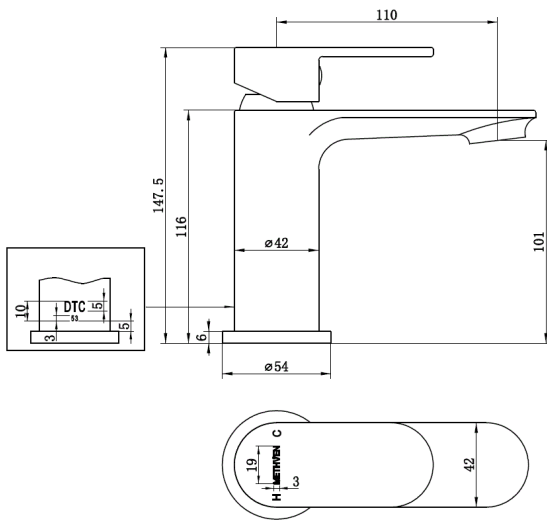

CONSTRUCTION: Brass

CARTRIDGE/VALVE TYPE: 35mm Ceramic Cartridge

SUPPLY: Suitable For Low Pressure Systems

INLET CONNECTIONS: 1/2" BSP

WORKING PRESSURES: 0.3 - 5.0 bar

OPERATION: Tilt and Turn Temperature and Flow Control

- Suitable For A Single Hole Basin
- Single Lever Operation
- Long Life 35Mm Ceramic Cartridge
- Fitted With 4 Litre Per Minute Directional Flow Regulator
- Complete With M10*1*400Mm, G1/2" Stainless Steel Flexible Hoses
- Includes Press Top Waste
- Tap Height: 147.5Mm
- Suitable For All Water Pressures

PABMCP

Chrome

Open Outlet Flow (Bar - l/min)

| BAR | 0.1 | 0.3 | 0.5 | 1.0 | 2.0 | 3.0 | 4.0 | 5.0 |
|-------------------|-----|-----|-----|-----|-----|-----|-----|-----|
| SPOUT FLOW | 1 | 1.8 | 2.5 | 3.3 | 3.5 | 3.7 | 3.8 | 3.8 |



2206351



Please Note: Flow rate will be dictated by installation configurations.
Please ensure to check the appropriate flow restrictor information if applicable.
*Please refer to website for full warranty details.

FREEPHONE: 0800 195 1602 | FAX ORDERS: 08444 068 690 | EMAIL: SALES@UK.METHVEN.COM

methven.com

THE INFORMATION ON THIS SPECIFICATION DOCUMENT WAS CORRECT AT THE DATE OF ISSUE. SOME VARIATION MAY OCCUR DUE TO THE MANUFACTURING TOLERANCES AND SITE SPECIFIC CONDITIONS.